

Amshore Osage, LLC
100 Park Avenue, Suite 700
Oklahoma City, OK 73102

RECEIVED
PUBLIC UTILITY
DIVISION

2016 OCT 28 PM 3 05

October 28, 2016

VIA HAND DELIVERY

Oklahoma Corporation Commission
P.O. Box 52000
Oklahoma City, OK 73152-2000

Attn: Brandy Wreath
Director
Public Utility Division

NOTICE RELATED TO CONSTRUCTION OF A WIND ENERGY FACILITY

Pursuant to Section 160.21 of Title 17 of the Oklahoma Statutes ("Section 160.21") and Section 165:35-45-4 of the Oklahoma Administrative Code ("Section 165:35-45-4"), Amshore Osage, LLC ("Company") hereby notifies the Oklahoma Corporation Commission ("Commission") of the construction of the Amshore Osage Wind Energy Project, (the "Project") located in Osage County, Oklahoma.

The Project has been under active development for several years. The most recent FAA form 7460-1 filing was made on September 8, 2016. A summary of the current FAA form 7460-1 filings for each wind turbine tower location within the Project boundary is attached as Exhibit A. Exhibit B to this letter presents a diagram indicating the Project boundary. As of the date of this notice, and based on the best publicly available data, Company attests, that the Project design is in full compliance with the setbacks set forth in Section 160.20 of Title 17 of the Oklahoma Statutes.

In accordance with the notification requirements of Sections 160.21 and 165:35-45-4, this notice will also be subsequently provided to the Board of the Osage County Commissioners. Evidence of that forthcoming notice is provided as Exhibit C. Since no Project facilities are located within an incorporated area of a municipality, no additional notice is required under either Sections 160.21 or 165:35-45-4.

Future correspondence regarding this matter should be directed to the following Company representative:

Jeff Neves
Amshore Osage, LLC
100 Park Avenue, Suite 700
Oklahoma City, OK 73102

361-844-6721 Telephone
361-888-4588 Fax

Sincerely yours,

A handwritten signature in black ink, appearing to read 'J. Neves', written over a horizontal line.

Jeff Neves
Vice President

cc: Natasha Scott, Deputy General Counsel for Public Utilities, General Counsel's Office
(with all exhibits, via overnight courier – Jim Thorpe Building, 2101 N. Lincoln,
Oklahoma City, OK 73105)

Exhibit A

(Summary of FAA Filings)

Below is a table containing filing numbers, structure name and height, location and elevation for each of the Project nuturbines which were included with the notices of permanent construction filed with the FAA. As was previously mentioned, the Project will be located in Osage County, Oklahoma and will not be located within the city limits of any municipality. Each turbine will have white paint and synchronized red lights.

ASN	Turbine Name	Longitude (NAD83)	Latitude (NAD83)	Ground Elevation (ft)	Structure Height (ft)	Date Accepted (FAA)
2016-WTW-10164-OE	T1	96° 56' 17.132" W	36° 39' 0.317" N	1,078	499	9/8/16
2016-WTW-10165-OE	T2	96° 56' 1.428" W	36° 39' 1.387" N	1,093	499	9/8/16
2016-WTW-10166-OE	T3	96° 55' 45.988" W	36° 39' 3.711" N	1,083	499	9/8/16
2016-WTW-10167-OE	T4	96° 55' 29.121" W	36° 39' 11.833" N	1,093	499	9/8/16
2016-WTW-10168-OE	T5	96° 55' 14.445" W	36° 39' 13.532" N	1,101	499	9/8/16
2016-WTW-10169-OE	T6	96° 54' 57.032" W	36° 39' 23.341" N	1,114	499	9/8/16
2016-WTW-10170-OE	T7	96° 54' 42.086" W	36° 39' 25.918" N	1,095	499	9/8/16
2016-WTW-10171-OE	T8	96° 54' 28.209" W	36° 39' 38.412" N	1,109	499	9/8/16
2016-WTW-10172-OE	T9	96° 54' 12.495" W	36° 39' 41.197" N	1,106	499	9/8/16
2016-WTW-10173-OE	T10	96° 53' 59.875" W	36° 39' 48.181" N	1,101	499	9/8/16
2016-WTW-10174-OE	T11	96° 53' 45.966" W	36° 39' 50.078" N	1,114	499	9/8/16
2016-WTW-10175-OE	T12	96° 53' 28.832" W	36° 40' 4.494" N	1,131	499	9/8/16
2016-WTW-10176-OE	T13	96° 53' 12.488" W	36° 40' 18.582" N	1,133	499	9/8/16
2016-WTW-10177-OE	T14	96° 52' 56.454" W	36° 40' 19.799" N	1,123	499	9/8/16
2016-WTW-10178-OE	T15	96° 52' 37.150" W	36° 40' 17.780" N	1,135	499	9/8/16
2016-WTW-10179-OE	T16	96° 52' 23.971" W	36° 40' 10.263" N	1,113	499	9/8/16

ASN	Turbine Name	Longitude (NAD83)	Latitude (NAD83)	Ground Elevation (ft)	Structure Height (ft)	Date Accepted (FAA)
2016-WTW-10180-OE	T17	96° 53' 29.471" W	36° 39' 24.248" N	1,099	499	9/8/16
2016-WTW-10181-OE	T18	96° 53' 15.991" W	36° 39' 24.403" N	1,085	499	9/8/16
2016-WTW-10182-OE	T19	96° 53' 0.201" W	36° 39' 27.184" N	1,073	499	9/8/16
2016-WTW-10183-OE	T20	96° 54' 40.236" W	36° 38' 50.185" N	1,075	499	9/8/16
2016-WTW-10184-OE	T21	96° 54' 25.687" W	36° 38' 47.479" N	1,081	499	9/8/16
2016-WTW-10185-OE	T22	96° 54' 13.368" W	36° 38' 39.754" N	1,051	499	9/8/16
2016-WTW-10186-OE	T23	96° 53' 32.805" W	36° 38' 41.322" N	1,070	499	9/8/16
2016-WTW-10187-OE	T24	96° 52' 56.786" W	36° 38' 57.853" N	1,036	499	9/8/16
2016-WTW-10188-OE	T25	96° 52' 36.899" W	36° 39' 0.302" N	1,084	499	9/8/16
2016-WTW-10189-OE	T26	96° 52' 49.266" W	36° 38' 31.257" N	1,041	499	9/8/16
2016-WTW-10190-OE	T27	96° 53' 0.774" W	36° 37' 49.543" N	1,047	499	9/8/16
2016-WTW-10191-OE	T28	96° 52' 46.790" W	36° 37' 51.194" N	1,096	499	9/8/16
2016-WTW-10192-OE	T29	96° 52' 32.928" W	36° 37' 51.150" N	1,042	499	9/8/16
2016-WTW-10193-OE	T30	96° 52' 18.992" W	36° 37' 50.470" N	1,038	499	9/8/16
2016-WTW-10194-OE	T31	96° 52' 19.978" W	36° 38' 30.175" N	1,103	499	9/8/16
2016-WTW-10195-OE	T32	96° 52' 7.358" W	36° 38' 24.420" N	1,106	499	9/8/16
2016-WTW-10196-OE	T33	96° 51' 53.575" W	36° 38' 22.258" N	1,060	499	9/8/16
2016-WTW-10197-OE	T34	96° 51' 39.820" W	36° 38' 20.133" N	1,034	499	9/8/16
2016-WTW-10198-OE	T35	96° 51' 21.628" W	36° 38' 22.605" N	1,067	499	9/8/16
2016-WTW-10199-OE	T36	96° 51' 5.666" W	36° 38' 23.917" N	1,062	499	9/8/16
2016-WTW-10200-OE	T37	96° 50' 40.039" W	36° 38' 35.119" N	1,080	499	9/8/16

ASN	Turbine Name	Longitude (NAD83)	Latitude (NAD83)	Ground Elevation (ft)	Structure Height (ft)	Date Accepted (FAA)
2016-WTW-10201-OE	T38	96° 50' 27.347" W	36° 38' 28.780" N	1,063	499	9/8/16
2016-WTW-10202-OE	T39	96° 50' 12.509" W	36° 38' 28.649" N	1,054	499	9/8/16
2016-WTW-10203-OE	T40	96° 52' 2.199" W	36° 38' 56.654" N	1,114	499	9/8/16
2016-WTW-10204-OE	T41	96° 51' 42.115" W	36° 39' 12.331" N	1,117	499	9/8/16
2016-WTW-10205-OE	T42	96° 51' 16.176" W	36° 39' 13.511" N	1,136	499	9/8/16
2016-WTW-10206-OE	T43	96° 51' 3.177" W	36° 39' 9.649" N	1,072	499	9/8/16
2016-WTW-10207-OE	T44	96° 50' 49.251" W	36° 39' 9.870" N	1,048	499	9/8/16
2016-WTW-10208-OE	T45	96° 51' 29.531" W	36° 39' 36.294" N	1,126	499	9/8/16
2016-WTW-10209-OE	T46	96° 50' 51.585" W	36° 39' 46.341" N	1,065	499	9/8/16
2016-WTW-10210-OE	T47	96° 50' 35.601" W	36° 39' 46.650" N	1,057	499	9/8/16
2016-WTW-10211-OE	T48	96° 51' 30.005" W	36° 40' 4.344" N	1,132	499	9/8/16
2016-WTW-10212-OE	T49	96° 51' 13.383" W	36° 40' 10.611" N	1,135	499	9/8/16
2016-WTW-10213-OE	T50	96° 50' 58.198" W	36° 40' 21.160" N	1,154	499	9/8/16
2016-WTW-10214-OE	T51	96° 50' 42.538" W	36° 40' 25.340" N	1,134	499	9/8/16
2016-WTW-10215-OE	T52	96° 50' 22.979" W	36° 40' 43.466" N	1,128	499	9/8/16
2016-WTW-10216-OE	T53	96° 50' 7.229" W	36° 40' 45.135" N	1,155	499	9/8/16
2016-WTW-10217-OE	T54	96° 49' 52.779" W	36° 40' 53.566" N	1,168	499	9/8/16
2016-WTW-10218-OE	T55	96° 49' 37.284" W	36° 40' 43.383" N	1,112	499	9/8/16
2016-WTW-10219-OE	T56	96° 49' 20.737" W	36° 40' 43.489" N	1,114	499	9/8/16
2016-WTW-10220-OE	T57	96° 50' 26.170" W	36° 41' 17.339" N	1,135	499	9/8/16
2016-WTW-10221-OE	T58	96° 49' 51.094" W	36° 41' 27.927" N	1,174	499	9/8/16

ASN	Turbine Name	Longitude (NAD83)	Latitude (NAD83)	Ground Elevation (ft)	Structure Height (ft)	Date Accepted (FAA)
2016-WTW-10222-OE	T59	96° 49' 37.216" W	36° 41' 25.175" N	1,159	499	9/8/16
2016-WTW-10223-OE	T60	96° 48' 46.749" W	36° 41' 35.868" N	1,142	499	9/8/16
2016-WTW-10224-OE	T61	96° 48' 31.485" W	36° 41' 35.941" N	1,164	499	9/8/16
2016-WTW-10225-OE	T62	96° 48' 17.036" W	36° 41' 28.192" N	1,162	499	9/8/16
2016-WTW-10226-OE	T63	96° 47' 59.696" W	36° 41' 17.112" N	1,161	499	9/8/16
2016-WTW-10227-OE	T64	96° 47' 45.366" W	36° 41' 5.857" N	1,161	499	9/8/16
2016-WTW-10228-OE	T65	96° 47' 28.749" W	36° 41' 9.305" N	1,122	499	9/8/16
2016-WTW-10229-OE	T66	96° 47' 14.879" W	36° 41' 12.858" N	1,060	499	9/8/16
2016-WTW-10230-OE	T67	96° 46' 58.922" W	36° 41' 14.143" N	1,041	499	9/8/16
2016-WTW-10231-OE	T68	96° 46' 37.351" W	36° 41' 12.430" N	1,007	499	9/8/16
2016-WTW-10232-OE	T69	96° 46' 20.148" W	36° 41' 32.788" N	1,024	499	9/8/16
2016-WTW-10233-OE	T70	96° 46' 4.540" W	36° 41' 33.715" N	1,017	499	9/8/16
2016-WTW-10234-OE	T71	96° 48' 46.430" W	36° 40' 32.441" N	1,051	499	9/8/16
2016-WTW-10235-OE	T72	96° 48' 21.399" W	36° 40' 30.561" N	1,048	499	9/8/16
2016-WTW-10236-OE	T73	96° 48' 5.308" W	36° 40' 31.393" N	1,046	499	9/8/16
2016-WTW-10237-OE	T74	96° 47' 26.856" W	36° 40' 32.091" N	1,045	499	9/8/16
2016-WTW-10238-OE	T75	96° 47' 11.674" W	36° 40' 29.387" N	1,051	499	9/8/16
2016-WTW-10239-OE	T76	96° 46' 54.275" W	36° 40' 26.723" N	1,032	499	9/8/16
2016-WTW-10240-OE	T77	96° 45' 3.585" W	36° 40' 30.218" N	1,012	499	9/8/16
2016-WTW-10241-OE	T78	96° 44' 51.197" W	36° 40' 21.634" N	1,011	499	9/8/16
2016-WTW-10242-OE	T79	96° 44' 36.841" W	36° 40' 28.364" N	1,023	499	9/8/16

ASN	Turbine Name	Longitude (NAD83)	Latitude (NAD83)	Ground Elevation (ft)	Structure Height (ft)	Date Accepted (FAA)
2016-WTW-10243-OE	T80	96° 47' 40.300" W	36° 39' 15.374" N	1,060	499	9/8/16
2016-WTW-10244-OE	T81	96° 47' 24.303" W	36° 39' 14.422" N	1,075	499	9/8/16
2016-WTW-10245-OE	T82	96° 47' 9.812" W	36° 39' 14.696" N	1,069	499	9/8/16
2016-WTW-10246-OE	T83	96° 46' 54.987" W	36° 39' 26.817" N	1,053	499	9/8/16
2016-WTW-10247-OE	T84	96° 46' 38.903" W	36° 39' 25.583" N	1,051	499	9/8/16
2016-WTW-10248-OE	T85	96° 46' 24.406" W	36° 39' 25.535" N	1,053	499	9/8/16
2016-WTW-10249-OE	T86	96° 46' 8.686" W	36° 39' 26.098" N	1,054	499	9/8/16
2016-WTW-10250-OE	T87	96° 45' 54.193" W	36° 39' 25.943" N	1,073	499	9/8/16
2016-WTW-10251-OE	T88	96° 45' 37.534" W	36° 39' 23.022" N	1,072	499	9/8/16
2016-WTW-10252-OE	T89	96° 45' 21.103" W	36° 39' 25.532" N	1,062	499	9/8/16
2016-WTW-10253-OE	T90	96° 45' 7.489" W	36° 39' 29.173" N	1,063	499	9/8/16
2016-WTW-10254-OE	T91	96° 44' 52.451" W	36° 39' 24.053" N	1,032	499	9/8/16
2016-WTW-10255-OE	T92	96° 44' 36.352" W	36° 39' 24.033" N	1,031	499	9/8/16
2016-WTW-10256-OE	T93	96° 44' 20.449" W	36° 39' 26.095" N	1,034	499	9/8/16
2016-WTW-10257-OE	T94	96° 43' 59.935" W	36° 39' 42.349" N	1,039	499	9/8/16
2016-WTW-10258-OE	T95	96° 43' 40.057" W	36° 39' 36.762" N	1,044	499	9/8/16
2016-WTW-10259-OE	T96	96° 45' 0.634" W	36° 38' 56.496" N	1,031	499	9/8/16
2016-WTW-10260-OE	T97	96° 44' 44.128" W	36° 38' 56.698" N	1,037	499	9/8/16
2016-WTW-10261-OE	T98	96° 45' 22.099" W	36° 38' 29.662" N	1,002	499	9/8/16
2016-WTW-10262-OE	T99	96° 45' 7.170" W	36° 38' 25.733" N	1,011	499	9/8/16
2016-WTW-10263-OE	T100	96° 44' 50.548" W	36° 38' 28.888" N	1,021	499	9/8/16

ASN	Turbine Name	Longitude (NAD83)	Latitude (NAD83)	Ground Elevation (ft)	Structure Height (ft)	Date Accepted (FAA)
2016-WTW-10264-OE	T101	96° 44' 34.460" W	36° 38' 29.640" N	1,050	499	9/8/16
2016-WTW-10265-OE	T102	96° 44' 18.352" W	36° 38' 29.301" N	1,048	499	9/8/16
2016-WTW-10266-OE	T103	96° 44' 3.625" W	36° 38' 32.579" N	1,045	499	9/8/16
2016-WTW-10267-OE	T104	96° 43' 50.333" W	36° 38' 23.001" N	1,045	499	9/8/16
2016-WTW-10268-OE	T105	96° 51' 16.039" W	36° 37' 46.837" N	1,047	499	9/8/16
2016-WTW-10269-OE	T106	96° 50' 58.429" W	36° 37' 50.269" N	1,062	499	9/8/16
2016-WTW-10270-OE	T107	96° 50' 38.107" W	36° 37' 54.127" N	1,027	499	9/8/16

Exhibit B
(Project Diagram)

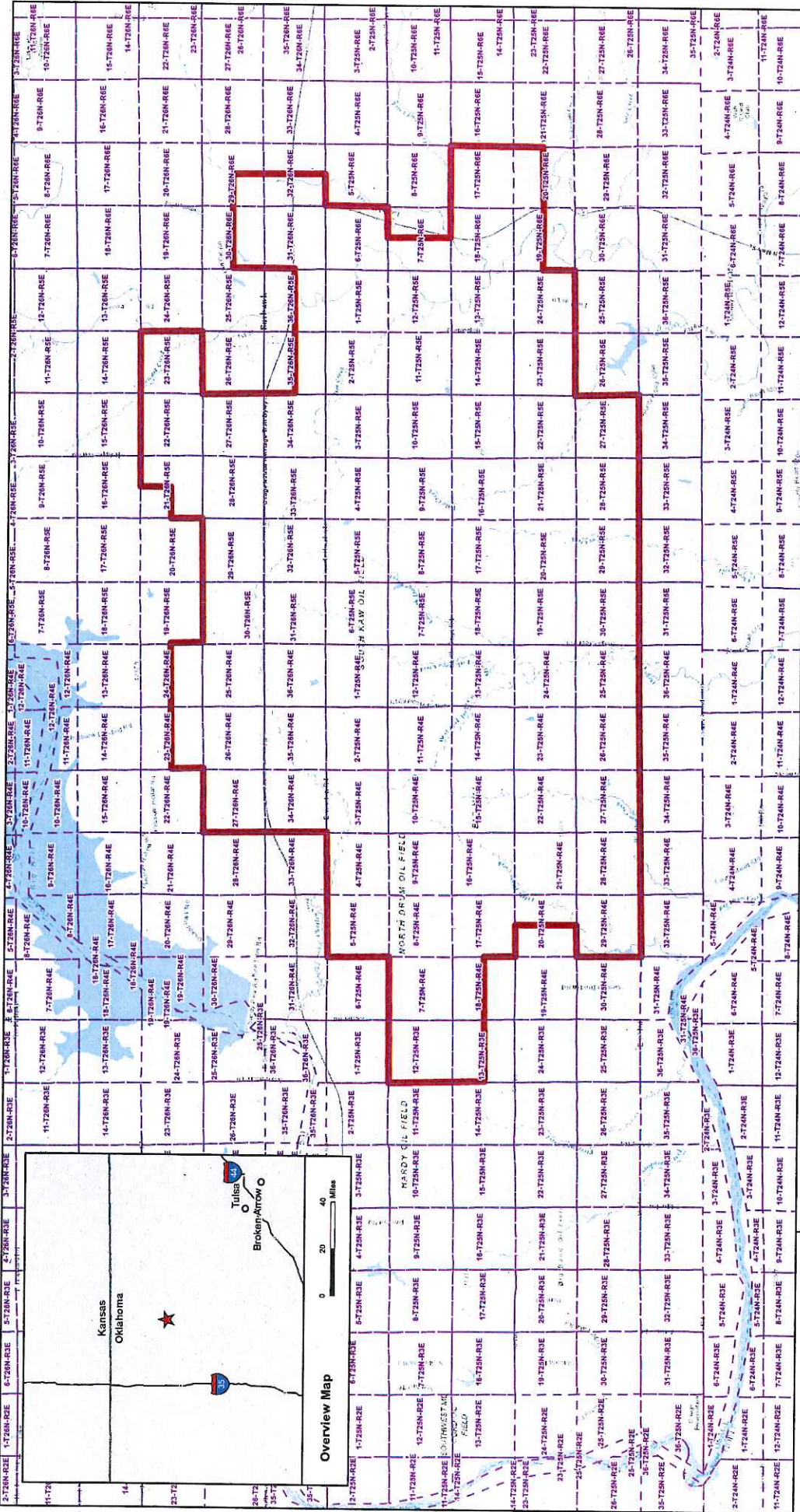

Project Location: Osage County, Oklahoma

0 1.5 Miles

North Arrow

EXHIBIT B

Prepared by: B. Richards Date: 10/27/2016

Amshore Osage, LLC
Amshore Osage Wind Project
 Site Location

Legend

- General Project Area
- Section Boundary

1221 South Maple Expressway, Suite 225
 Ardmore, Oklahoma 73402-1105
 www.energyrenewalpartners.com

ERP
 ENERGY RENEWAL PARTNERS, LLC