

March 6, 2017

Director of Public Utility Division
Oklahoma Corporation Commission
P.O. Box 52000
Oklahoma City, OK 73152-2000

Re: Combined Notice of Intent to Construct Wind Energy Facility and Notice of Public Meeting

Pursuant to 17 O.S. §160.21 (A) and OAC 165:35-45-4 (a), please take notice that North Buffalo Wind, L.L.C. (the "Owner") intends to build the Persimmon Creek I wind energy facility (the "Facility") in the counties of Ellis, Dewey and Woodward, in the State of Oklahoma. The commencement of construction is scheduled to occur on April 10, 2017. A public meeting is scheduled for March 23, 2017, at 2:00 P.M., at the Woodward Conference Center located at 3401 Centennial Drive, Woodward, Oklahoma, 73801.

The most recent FAA Form 7460-1 was filed with the Federal Aviation Administration (the "FAA") on December 20, 2016, and a summary of the FAA filing, including the coordinates of each turbine is attached as Exhibit A. Also, a diagram graphically depicting the boundary of the Facility, including the outer perimeter, is attached as Exhibit B.

A Notice of Intent to Construct Wind Energy Facility (the "Notice") has been sent by certified mail to all parties entitled to notice of intent to construct the Facility as oil, gas and other mineral operators and lessees designated by 52 O.S. §803(C). The Notice included: (i) the scheduled commencement of construction date for the Facility, and (ii) maps or plats of the proposed location of all of the various elements of the Facility to be located on the governmental section which may affect each such party.

This Notice of Intent to Construct Wind Energy Facility and Notice of Public Meeting (this "Combined Notice") is being: (i) delivered to the respective boards of county commissioners of the counties in which all or a portion of the Facility is to be located within twenty-four (24) hours of the filing hereof pursuant to 17 O.S. §160.21(A), 17 O.S. §160.21(C), OAC 165:35-45-4(d) and OAC 165:35-45-4(f), (ii) published pursuant to 52 O.S. §803(D), 17 O.S. §160.21(B) and OAC 165:35-45-4(e), and (iii) published pursuant to 17 O.S. §160.21(C) and OAC 165:35-45-4(f).

Owner will submit proof of the referenced publications to the Director of the Public Utility Division of the Oklahoma Corporation Commission upon receipt thereof pursuant to 17 O.S. §160.21(B), 17 O.S. §160.21(C), OAC 165:35-45-4(e) and OAC 165:35-45-4(f).

This Notice is not being provided to the governing body of any municipality since the Facility is not being located in the incorporated area of any municipality.

In the event that this Notice is deemed to be a "Report" pursuant to 17 O.S. §160.20 (B), Owner attests to compliance with the setback requirements of 17 O.S. §160.20(A).

Owner requests affirmation of submission of this Notice by providing proof of receipt stamp pursuant to OAC 165:35-45-4(b).

North Buffalo Wind, L.L.C.,
By its sole Member,
Gestamp Wind North America Inc.

By: Javier Mateache Sacristan
Title: President

Exhibit "A" Summary of FAA Filing

User label	Latitude ±ddmmss.ss	Longitude ±dddmmss.ss	Z Map	Lightin g	Superseded #
WTG01	36°07'20.00"	-99°20'55.64"	2295	Y	2016-WTW-636-OE
WTG02	36°07'22.71"	-99°21'09.65"	2290	Y	2016-WTW-637-OE
WTG03	36°07'28.37"	-99°21'28.80"	2280	N	2016-WTW-638-OE
WTG04	36°07'26.44"	-99°21'45.76"	2274	Y	2016-WTW-639-OE
WTG05	36°07'41.42"	-99°24'38.90"	2347	Y	2016-WTW-640-OE
WTG06	36°07'42.61"	-99°24'24.66"	2375	N	2016-WTW-641-OE
WTG07	36°07'53.87"	-99°24'06.56"	2370	Y	2016-WTW-642-OE
WTG08	36°07'54.20"	-99°23'52.75"	2382	N	2016-WTW-643-OE
WTG09	36°07'54.02"	-99°23'39.55"	2388	Y	2016-WTW-644-OE
WTG10	36°07'56.44"	-99°23'25.60"	2360	N	2016-WTW-645-OE
WTG11	36°07'56.36"	-99°23'09.95"	2289	Y	New
WTG12	36°08'04.77"	-99°22'47.83"	2330	Y	2016-WTW-648-OE
WTG13	36°08'06.67"	-99°22'31.99"	2310	N	2016-WTW-649-OE
WTG14	36°08'07.08"	-99°22'15.63"	2290	Y	2016-WTW-651-OE
WTG15	36°08'07.22"	-99°22'02.31"	2315	N	2016-WTW-652-OE
WTG16	36°08'06.70"	-99°21'49.06"	2320	Y	2016-WTW-654-OE
WTG17	36°08'10.90"	-99°21'35.44"	2305	N	2016-WTW-656-OE
WTG18	36°08'13.31"	-99°21'21.84"	2298	Y	2016-WTW-659-OE
WTG19	36°08'16.40"	-99°21'08.13"	2282	N	2016-WTW-660-OE
WTG20	36°08'19.46"	-99°20'54.54"	2265	Y	2016-WTW-662-OE
WTG21	36°09'02.67"	-99°23'47.66"	2320	Y	2016-WTW-665-OE
WTG22	36°09'02.98"	-99°23'34.17"	2339	N	2016-WTW-667-OE
WTG23	36°09'03.67"	-99°23'20.49"	2351	Y	2016-WTW-669-OE

Exhibit "A" Summary of FAA Filing

WTG24	36°09'04.23"	-99°23'06.93"	2318	N	2016-WTW-670-OE
WTG25	36°09'04.62"	-99°22'47.88"	2314	Y	2016-WTW-705-OE
WTG26	36°09'09.87"	-99°22'29.05"	2320	N	2016-WTW-706-OE
WTG27	36°09'12.12"	-99°22'15.38"	2297	Y	2016-WTW-707-OE
WTG28	36°09'14.01"	-99°22'01.82"	2305	N	2016-WTW-708-OE
WTG29	36°09'13.08"	-99°21'48.65"	2300	Y	2016-WTW-724-OE
WTG30	36°09'10.81"	-99°21'35.67"	2288	N	2016-WTW-709-OE
WTG31	36°09'08.22"	-99°21'22.73"	2300	Y	2016-WTW-710-OE
WTG32	36°09'03.04"	-99°21'09.94"	2289	N	2016-WTW-711-OE
WTG33	36°08'57.78"	-99°20'57.15"	2288	Y	New
WTG34	36°10'00.98"	-99°21'07.72"	2280	Y	New
WTG35	36°10'02.53"	-99°20'34.42"	2270	Y	New
WTG36	36°10'06.24"	-99°20'21.31"	2260	N	New
WTG37	36°10'09.07"	-99°20'05.99"	2234	Y	New
WTG38	36°10'09.31"	-99°19'51.78"	2205	Y	New
WTG39	36°10'42.15"	-99°22'46.55"	2303	Y	2016-WTW-719-OE
WTG40	36°10'44.03"	-99°22'28.78"	2355	N	2016-WTW-720-OE
WTG41	36°10'44.04"	-99°22'15.25"	2278	Y	2016-WTW-721-OE
WTG42	36°10'43.22"	-99°21'45.98"	2259	Y	2016-WTW-646-OE
WTG43	36°10'40.79"	-99°21'33.00"	2268	N	2016-WTW-650-OE
WTG44	36°10'38.49"	-99°21'20.10"	2269	Y	2016-WTW-653-OE
WTG45	36°10'37.10"	-99°21'07.00"	2282	N	2016-WTW-655-OE
WTG46	36°10'37.04"	-99°20'53.63"	2273	Y	2016-WTW-657-OE
WTG47	36°10'45.00"	-99°20'40.49"	2248	N	2016-WTW-658-OE
WTG48	36°10'45.82"	-99°20'27.13"	2241	Y	2016-WTW-661-OE
WTG49	36°10'44.95"	-99°20'02.74"	2218	Y	2016-WTW-663-OE

Exhibit "A" Summary of FAA Filing

WTG50	36°10'39.30"	-99°19'50.59"	2200	N	2016-WTW-664-OE
WTG51	36°10'36.26"	-99°19'35.48"	2181	Y	2016-WTW-666-OE
WTG52	36°10'31.57"	-99°18'50.67"	2170	Y	2016-WTW-668-OE
WTG53	36°10'46.56"	-99°18'27.71"	2155	N	New
WTG54	36°10'45.72"	-99°18'13.77"	2148	Y	New
WTG55	36°10'45.47"	-99°17'59.68"	2165	N	New
WTG56	36°10'50.14"	-99°17'45.05"	2140	Y	New
WTG57	36°09'26.90"	-99°16'21.04"	2230	Y	New
WTG58	36°09'26.93"	-99°16'07.00"	2240	N	New
WTG59	36°09'27.06"	-99°15'53.23"	2230	Y	New
WTG60	36°09'28.13"	-99°15'39.30"	2181	N	2016-WTW-678-OE
WTG61	36°09'38.25"	-99°15'25.09"	2175	Y	2016-WTW-679-OE
WTG62	36°09'42.60"	-99°15'11.50"	2164	N	2016-WTW-680-OE
WTG63	36°09'44.32"	-99°14'57.37"	2140	Y	2016-WTW-681-OE
WTG64	36°09'48.02"	-99°14'39.37"	2109	Y	New
WTG65	36°10'06.46"	-99°16'06.89"	2167	Y	2016-WTW-683-OE
WTG66	36°10'07.70"	-99°15'49.40"	2212	N	New
WTG67	36°10'07.44"	-99°15'35.23"	2224	Y	New
WTG68	36°10'41.26"	-99°15'18.89"	2211	Y	2016-WTW-686-OE
WTG69	36°10'37.56"	-99°15'04.95"	2160	N	2016-WTW-687-OE
WTG70	36°10'36.81"	-99°14'50.33"	2163	N	2016-WTW-688-OE
WTG71	36°10'34.66"	-99°14'37.27"	2145	Y	2016-WTW-689-OE
WTG72	36°10'40.61"	-99°13'07.66"	2038	Y	New
WTG73	36°10'35.06"	-99°12'54.55"	2040	N	New
WTG74	36°10'30.11"	-99°12'41.33"	2028	Y	New
WTG75	36°10'17.40"	-99°11'35.64"	1997	Y	New
WTG76	36°10'17.10"	-99°11'21.99"	1969	Y	New
WTG77	36°11'37.89"	-99°15'06.02"	2097	Y	2016-WTW-696-OE
WTG78	36°11'37.24"	-99°14'52.76"	2111	N	2016-WTW-697-OE
WTG79	36°11'36.62"	-99°14'39.43"	2119	Y	2016-WTW-698-OE

Exhibit "A" Summary of FAA Filing

WTG80	36°11'35.44"	-99°22'06.24"	2228	Y	2016-WTW-701-OE
WTG81	36°11'33.86"	-99°21'53.14"	2194	N	2016-WTW-702-OE
WTG82	36°11'34.48"	-99°21'39.69"	2184	N	2016-WTW-703-OE
WTG83	36°11'34.30"	-99°21'26.40"	2182	Y	2016-WTW-704-OE
WTG84	36°11'38.59"	-99°20'40.81"	2203	Y	New
WTG85	36°11'38.47"	-99°20'23.83"	2230	Y	New
WTG86	36°11'51.46"	-99°19'09.61"	2142	Y	New
WTG87	36°11'57.16"	-99°18'53.09"	2151	N	New
WTG88	36°12'00.89"	-99°18'38.73"	2170	N	New
WTG89	36°12'03.01"	-99°18'24.48"	2165	Y	New
WTG90	36°12'26.90"	-99°17'56.54"	2130	Y	New
WTG91	36°12'28.53"	-99°17'42.33"	2115	N	New
WTG92	36°12'32.49"	-99°17'27.21"	2108	N	New
WTG93	36°12'35.87"	-99°17'11.04"	2095	Y	New
WTG94	36°12'40.52"	-99°16'56.28"	2064	N	New
WTG95	36°12'45.94"	-99°16'41.12"	2036	Y	New

Exhibit "g"
Persimmon Creek Wind Farm

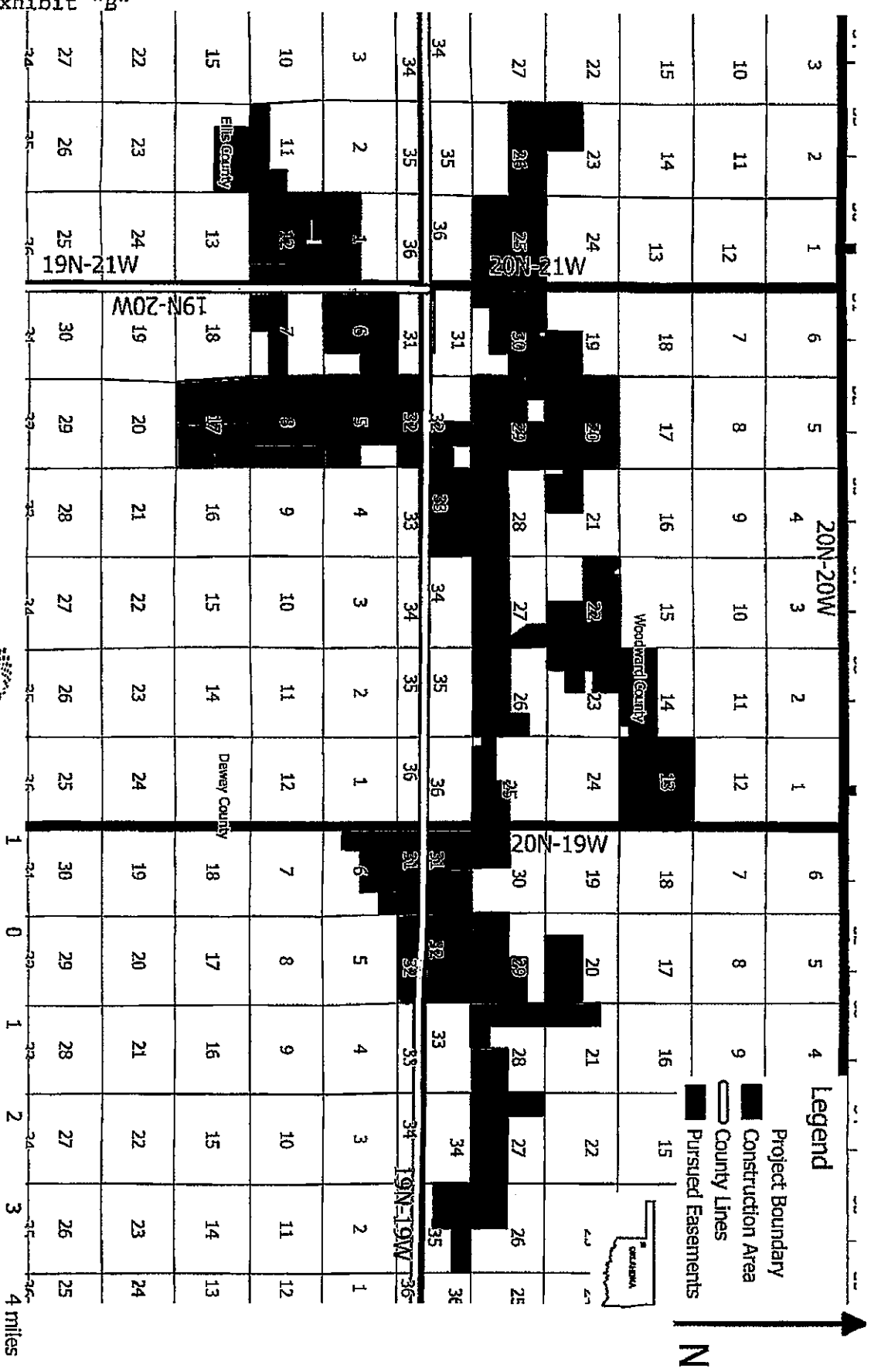

Proprietary and Confidential, North Buffalo Wind LLC



Exhibit "g"