

Jennifer Ivester Berry  
Of Counsel

Direct 405.552.2428  
jiberry@phillipsmurrah.com

VIA EMAIL: pudsubmissions@occemail.com

December 5, 2018

Public Utility Division  
Oklahoma Corporation Commission  
Jim Thorpe Building  
2101 N. Lincoln  
Oklahoma City, Oklahoma 73105

*Re: Cowboy Ridge Wind Energy Project – Ellis County, Oklahoma*

In connection with the referenced project, and on behalf of our client, Cowboy Ridge Project LLC, a Delaware limited liability company, please find attached a copy of the Notice of Intent to Construct (the "Notice").

The attached documents are being provided to you pursuant to 17 O.S. § 160.11 et. seq. Upon receipt, please confirm by reply email that you have received this letter and all attachments. Further, we request that, upon receipt of the letter from the Oklahoma Strategic Military Planning Commission to be filed with you pursuant to 17 O.S. §160.21(B), you provide us a copy of the same for our records. We will also send you, via a separate email and under a separate cover letter the Determination of No Hazards for this project.

If you have any questions about this letter, the enclosures or the referenced project, please let me know.

Regards,

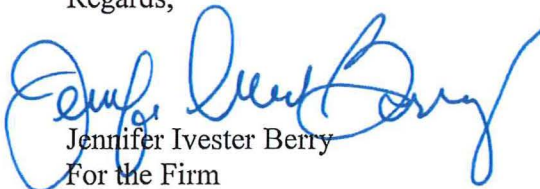

Jennifer Ivester Berry  
For the Firm

Enclosures  
1297046.DOCX

cc: Matthew McCluskey - Director, Development  
EDF Renewables Development, Inc.

The Power of a Strategic Partner.®

Cowboy Ridge Project, LLC  
c/o EDF Renewable Energy  
15545 Innovation Drive  
San Diego, CA 92128

November 28, 2018

**Delivered Via Email:** [pudsubmissions@occemail.com](mailto:pudsubmissions@occemail.com)

Public Utility Division  
Oklahoma Corporation Commission  
P.O. Box 52000  
Oklahoma City, OK 73152-2000

**NOTICE OF INTENT TO CONSTRUCT – ELLIS COUNTY**

Dear Commission:

In order to comply with the requirements of Title 17, Section 160.11 *et. seq.* of the Oklahoma Statutes, and the rules promulgated by the Oklahoma Corporation Commission (the “Commission”), Cowboy Ridge Project LLC, a Delaware limited liability company (the “Company”), hereby informs the Commission of its intent to construct the Cowboy Ridge wind energy project (the “Project”) located in Ellis County, Oklahoma.

Please be advised that the initial FAA form 7460-1 filings were made on July 14, 2018 and a summary of the FAA form 7460-1 filings for each proposed wind turbine tower location within the Project boundary is attached hereto as Exhibit A. In addition, attached hereto as Exhibit B is a depiction of the Project boundary, which shows the real estate included and evaluated in connection with the statutory setback requirements set forth in 17 O.S. §160.20. Based on information made available to the public, the Company attests that on the date of this notice, the Project design complies with the setbacks required by title 17 O.S. §160.20. In the event any designs and plans are developed that require modification to the wind turbine locations or Project boundary, the Company will provide a copy of the same to the Commission.

In accordance with the notification requirements of 17 O.S. §160.21 and Oklahoma Administrative Code (“OAC”) 165:35-45-4, this notice and all Exhibits are being simultaneously provided to (i) the Ellis County Board of Commissioners; and (ii) the Oklahoma Strategic Military Planning Commission (“OSMPC”), as evidenced by the “cc” information at the end of this letter. None of the Project facilities are located within an incorporated area of a municipality such that no additional notice is required under title 17 O.S. §160.21(A) or OAC 165:35-45-4.

Please do not hesitate to contact us at (281) 921-9775 with any questions regarding this submission.

Sincerely,



Matthew McCluskey  
Director, Development  
[Matthew.McCluskey@edf-re.com](mailto:Matthew.McCluskey@edf-re.com)

Cowboy Ridge Project, LLC  
c/o EDF Renewable Energy  
15545 Innovation Drive  
San Diego, CA 92128

cc: Ellis County Commissioners (*via email and FedEx*)  
100 S Washington St.  
Arnett, Oklahoma 73832

Oklahoma Strategic Military Planning Commission (*via Hand Delivery*)  
Office of the Governor  
State Capitol Building  
Oklahoma City, Oklahoma 73105

# Exhibit A

TID	ASN	N83_X_dms	N83_Y_dms	Elev_Ft	easting	northing
1	2018-WTW-10615-OE	99° 42' 29.46" W	36° 14' 9.45" N	2409.437	1464761	454343.9
2	2018-WTW-10616-OE	99° 42' 55.09" W	36° 14' 10.44" N	2428.863	1462664	454480
3	2018-WTW-10617-OE	99° 43' 8.30" W	36° 14' 8.76" N	2366.641	1461579	454329.9
4	2018-WTW-10618-OE	99° 45' 4.30" W	36° 14' 3.76" N	2330.743	1452069	453993.7
5	2018-WTW-10619-OE	99° 45' 17.93" W	36° 14' 3.22" N	2352.854	1450951	453959.9
6	2018-WTW-10620-OE	99° 42' 28.00" W	36° 13' 47.38" N	2358.21	1464842	452110.2
7	2018-WTW-10621-OE	99° 42' 41.07" W	36° 13' 47.50" N	2427.276	1463772	452141
8	2018-WTW-10622-OE	99° 42' 54.28" W	36° 13' 45.88" N	2366.044	1462686	451996.2
9	2018-WTW-10623-OE	99° 42' 37.40" W	36° 13' 10.39" N	2374.661	1464006	448383.8
10	2018-WTW-10624-OE	99° 42' 53.91" W	36° 13' 5.26" N	2442.288	1462644	447888.6
11	2018-WTW-10625-OE	99° 43' 7.78" W	36° 13' 12.40" N	2440.957	1461520	448631.1
12	2018-WTW-10626-OE	99° 43' 38.47" W	36° 13' 35.56" N	2351.8	1459048	451017.2
13	2018-WTW-10627-OE	99° 43' 54.86" W	36° 13' 44.50" N	2317.171	1457721	451944.7
14	2018-WTW-10628-OE	99° 44' 1.18" W	36° 13' 47.51" N	2326.381	1457209	452258.3
15	2018-WTW-10629-OE	99° 44' 11.62" W	36° 13' 37.35" N	2323.373	1456336	451246.7
16	2018-WTW-10630-OE	99° 43' 36.88" W	36° 13' 16.41" N	2391.169	1459144	449078.1
17	2018-WTW-10631-OE	99° 43' 52.56" W	36° 13' 8.38" N	2395.306	1457845	448289.5
18	2018-WTW-10632-OE	99° 44' 49.39" W	36° 13' 21.62" N	2323.171	1453213	449712
19	2018-WTW-10633-OE	99° 45' 9.74" W	36° 13' 19.90" N	2361.127	1451543	449568.2
20	2018-WTW-10634-OE	99° 45' 17.24" W	36° 13' 20.28" N	2370.597	1450929	449617.4
21	2018-WTW-10635-OE	99° 45' 53.17" W	36° 13' 47.90" N	2353.544	1448036	452463.4
22	2018-WTW-10636-OE	99° 46' 14.42" W	36° 13' 41.58" N	2344.895	1446284	451855.4
23	2018-WTW-10637-OE	99° 45' 51.05" W	36° 13' 28.46" N	2398.784	1448175	450494.6
24	2018-WTW-10638-OE	99° 46' 1.98" W	36° 13' 32.04" N	2362.51	1447286	450872.8
25	2018-WTW-10639-OE	99° 46' 9.77" W	36° 13' 20.54" N	2346.033	1446626	449721.2
26	2018-WTW-10640-OE	99° 45' 38.43" W	36° 13' 9.24" N	2392.035	1449173	448532.3
27	2018-WTW-10641-OE	99° 45' 53.46" W	36° 13' 8.64" N	2368.548	1447941	448494.4
28	2018-WTW-10642-OE	99° 46' 50.98" W	36° 13' 8.07" N	2362.691	1443227	448522.3
29	2018-WTW-10643-OE	99° 47' 9.73" W	36° 13' 7.07" N	2356.808	1441690	448449.9
30	2018-WTW-10644-OE	99° 47' 21.16" W	36° 13' 16.33" N	2386.772	1440770	449403.3
31	2018-WTW-10645-OE	99° 48' 2.92" W	36° 13' 17.49" N	2336.944	1437352	449583.8
32	2018-WTW-10646-OE	99° 48' 16.68" W	36° 13' 7.48" N	2347.711	1436205	448592.7
33	2018-WTW-10647-OE	99° 48' 26.93" W	36° 13' 10.77" N	2367.34	1435372	448940.9
34	2018-WTW-10648-OE	99° 48' 44.88" W	36° 13' 19.96" N	2383.055	1433919	449897.8
35	2018-WTW-10649-OE	99° 42' 33.71" W	36° 12' 49.96" N	2357.82	1464272	446312.4
36	2018-WTW-10650-OE	99° 42' 50.50" W	36° 12' 54.87" N	2433.783	1462905	446833.7
37	2018-WTW-10651-OE	99° 43' 11.40" W	36° 12' 46.51" N	2454.295	1461177	446018.9
38	2018-WTW-10652-OE	99° 42' 36.71" W	36° 12' 25.40" N	2370.26	1463982	443834.3
39	2018-WTW-10653-OE	99° 42' 49.95" W	36° 12' 25.75" N	2441.036	1462898	443888.2
40	2018-WTW-10654-OE	99° 43' 1.68" W	36° 12' 12.51" N	2443.818	1461914	442567.2
41	2018-WTW-10655-OE	99° 43' 13.19" W	36° 12' 22.33" N	2395.602	1460988	443576.4
42	2018-WTW-10656-OE	99° 43' 22.71" W	36° 12' 40.70" N	2438.85	1460241	445447.8
43	2018-WTW-10657-OE	99° 43' 43.62" W	36° 12' 54.10" N	2430.293	1458551	446832.4
44	2018-WTW-10658-OE	99° 43' 39.82" W	36° 12' 44.90" N	2440.933	1458846	445897.2
45	2018-WTW-10659-OE	99° 43' 37.25" W	36° 12' 33.80" N	2372.844	1459037	444771.5
46	2018-WTW-10660-OE	99° 43' 54.00" W	36° 12' 41.50" N	2363.457	1457678	445574

47	2018-WTW-10661-OE	99° 44' 8.48" W	36° 12' 57.28" N	2358.86	1456521	447190.4
48	2018-WTW-10662-OE	99° 44' 11.65" W	36° 12' 16.09" N	2364.353	1456187	443030.5
49	2018-WTW-10663-OE	99° 44' 27.84" W	36° 12' 15.99" N	2401.686	1454860	443044.4
50	2018-WTW-10664-OE	99° 44' 40.69" W	36° 12' 19.70" N	2359.545	1453813	443438.5
51	2018-WTW-10665-OE	99° 45' 34.28" W	36° 12' 41.59" N	2459.05	1449462	445731.1
52	2018-WTW-10666-OE	99° 45' 46.27" W	36° 12' 50.82" N	2411.32	1448497	446682.3
53	2018-WTW-10667-OE	99° 46' 3.29" W	36° 12' 54.90" N	2360.146	1447110	447120.2
54	2018-WTW-10668-OE	99° 46' 2.77" W	36° 12' 41.99" N	2371.348	1447129	445813.5
55	2018-WTW-10669-OE	99° 46' 14.64" W	36° 12' 44.65" N	2357.561	1446161	446100.4
56	2018-WTW-10670-OE	99° 45' 41.45" W	36° 12' 14.89" N	2453.232	1448826	443042
57	2018-WTW-10671-OE	99° 45' 52.45" W	36° 12' 27.45" N	2436.168	1447948	444328.3
58	2018-WTW-10672-OE	99° 46' 5.95" W	36° 12' 28.15" N	2377.612	1446843	444419.1
59	2018-WTW-10673-OE	99° 46' 42.18" W	36° 12' 54.40" N	2374.205	1443923	447127.1
60	2018-WTW-10674-OE	99° 46' 52.06" W	36° 12' 39.89" N	2396.904	1443087	445674.8
61	2018-WTW-10675-OE	99° 47' 54.56" W	36° 12' 36.47" N	2361.823	1437960	445423.7
62	2018-WTW-10676-OE	99° 48' 17.24" W	36° 12' 27.14" N	2362.18	1436083	444514.7
63	2018-WTW-10677-OE	99° 48' 19.61" W	36° 12' 14.56" N	2387.913	1435866	443247.1
64	2018-WTW-10678-OE	99° 49' 4.23" W	36° 12' 46.29" N	2401.944	1432270	446522.4
65	2018-WTW-10679-OE	99° 49' 17.05" W	36° 12' 43.13" N	2415.369	1431214	446223.6
66	2018-WTW-10680-OE	99° 49' 27.19" W	36° 12' 43.31" N	2406.028	1430383	446256.7
67	2018-WTW-10681-OE	99° 50' 0.51" W	36° 12' 42.35" N	2391.522	1427651	446211.1
68	2018-WTW-10682-OE	99° 50' 15.68" W	36° 12' 36.90" N	2370.931	1426398	445683.6
69	2018-WTW-10683-OE	99° 50' 26.45" W	36° 12' 36.17" N	2376.758	1425514	445626.8
70	2018-WTW-10684-OE	99° 50' 37.85" W	36° 12' 36.93" N	2363.274	1424581	445721.6
71	2018-WTW-10685-OE	99° 51' 0.70" W	36° 12' 36.67" N	2361.083	1422709	445731.1
72	2018-WTW-10686-OE	99° 51' 9.26" W	36° 12' 30.80" N	2374.85	1421996	445150.9
73	2018-WTW-10687-OE	99° 50' 54.62" W	36° 12' 13.66" N	2375.277	1423163	443394.6
74	2018-WTW-10688-OE	99° 51' 39.56" W	36° 12' 15.65" N	2432.177	1419485	443666.7
75	2018-WTW-10689-OE	99° 42' 36.60" W	36° 11' 57.10" N	2420.441	1463941	440972.5
76	2018-WTW-10690-OE	99° 42' 27.70" W	36° 11' 36.26" N	2387.525	1464633	438853
77	2018-WTW-10691-OE	99° 42' 40.76" W	36° 11' 33.26" N	2442.879	1463558	438568.6
78	2018-WTW-10692-OE	99° 42' 54.24" W	36° 11' 32.99" N	2434.405	1462453	438560.7
79	2018-WTW-10693-OE	99° 43' 7.70" W	36° 11' 32.84" N	2454.344	1461349	438564.4
80	2018-WTW-10694-OE	99° 43' 24.29" W	36° 11' 55.58" N	2446.225	1460030	440888.3
81	2018-WTW-10695-OE	99° 43' 37.21" W	36° 11' 56.65" N	2411.837	1458973	441015.3
82	2018-WTW-10696-OE	99° 43' 51.86" W	36° 11' 57.04" N	2370.584	1457774	441075.8
83	2018-WTW-10697-OE	99° 44' 4.94" W	36° 11' 59.74" N	2377.583	1456707	441367.6
84	2018-WTW-10698-OE	99° 44' 5.89" W	36° 11' 47.21" N	2373.212	1456606	440102.6
85	2018-WTW-10699-OE	99° 43' 24.51" W	36° 11' 34.50" N	2398.759	1459974	438757
86	2018-WTW-10700-OE	99° 43' 38.65" W	36° 11' 32.26" N	2404.15	1458812	438551
87	2018-WTW-10701-OE	99° 43' 55.71" W	36° 11' 22.99" N	2401.581	1457396	437638.6
88	2018-WTW-10702-OE	99° 44' 8.71" W	36° 11' 23.56" N	2459.92	1456332	437715.4
89	2018-WTW-10703-OE	99° 44' 27.29" W	36° 11' 57.87" N	2429.363	1454872	441211.4
90	2018-WTW-10704-OE	99° 44' 35.51" W	36° 11' 58.51" N	2386.001	1454200	441288.1
91	2018-WTW-10705-OE	99° 44' 43.29" W	36° 11' 58.82" N	2372.456	1453562	441331
92	2018-WTW-10706-OE	99° 45' 16.35" W	36° 12' 0.87" N	2378.346	1450857	441587.2
93	2018-WTW-10707-OE	99° 45' 10.87" W	36° 11' 53.71" N	2364.501	1451293	440855.7

94	2018-WTW-10708-OE	99° 44' 27.77" W	36° 11' 25.72" N	2403.093	1454774	437962.2
95	2018-WTW-10709-OE	99° 44' 43.68" W	36° 11' 28.67" N	2382.614	1453476	438284
96	2018-WTW-10710-OE	99° 44' 56.26" W	36° 11' 34.05" N	2370.388	1452455	438845.7
97	2018-WTW-10711-OE	99° 45' 17.44" W	36° 11' 31.89" N	2387.669	1450714	438659.4
98	2018-WTW-10712-OE	99° 45' 50.85" W	36° 11' 55.12" N	2462.905	1448019	441056.8
99	2018-WTW-10713-OE	99° 46' 8.97" W	36° 11' 50.07" N	2386.007	1446525	440573.9
100	2018-WTW-10714-OE	99° 45' 34.43" W	36° 11' 34.85" N	2397.647	1449328	438983
101	2018-WTW-10715-OE	99° 45' 54.16" W	36° 11' 22.81" N	2475.252	1447689	437795.5
102	2018-WTW-10716-OE	99° 46' 7.23" W	36° 11' 22.68" N	2416.9	1446617	437802.2
103	2018-WTW-10717-OE	99° 47' 7.45" W	36° 12' 1.12" N	2372.841	1441754	441778.5
104	2018-WTW-10718-OE	99° 47' 20.61" W	36° 12' 2.15" N	2364.53	1440677	441902.6
105	2018-WTW-10719-OE	99° 46' 46.65" W	36° 11' 44.67" N	2470.989	1443427	440083.8
106	2018-WTW-10720-OE	99° 46' 53.71" W	36° 11' 45.18" N	2463.911	1442850	440146
107	2018-WTW-10721-OE	99° 47' 5.88" W	36° 11' 39.66" N	2407.77	1441843	439606.8
108	2018-WTW-10722-OE	99° 47' 17.37" W	36° 11' 39.23" N	2378.609	1440900	439580.1
109	2018-WTW-10723-OE	99° 46' 42.47" W	36° 11' 32.51" N	2432.615	1443748	438848.9
110	2018-WTW-10724-OE	99° 47' 25.43" W	36° 11' 22.53" N	2372.112	1440208	437904.6
111	2018-WTW-10725-OE	99° 47' 45.04" W	36° 11' 32.50" N	2411.667	1438619	438942.1
112	2018-WTW-10726-OE	99° 48' 1.79" W	36° 11' 37.74" N	2442.054	1437257	439497.3
113	2018-WTW-10727-OE	99° 48' 27.89" W	36° 11' 39.22" N	2453.336	1435121	439686
114	2018-WTW-10728-OE	99° 47' 43.82" W	36° 11' 23.31" N	2418.276	1438703	438011.2
115	2018-WTW-10729-OE	99° 48' 0.76" W	36° 11' 23.42" N	2454.793	1437314	438047.3
116	2018-WTW-10730-OE	99° 48' 27.55" W	36° 11' 22.66" N	2461.308	1435118	438011.8
117	2018-WTW-10731-OE	99° 48' 45.95" W	36° 11' 35.24" N	2403.118	1433633	439311.5
118	2018-WTW-10732-OE	99° 48' 53.03" W	36° 11' 41.04" N	2388.941	1433064	439909.1
119	2018-WTW-10733-OE	99° 49' 6.23" W	36° 11' 40.02" N	2383.387	1431980	439825.8
120	2018-WTW-10734-OE	99° 49' 13.39" W	36° 11' 34.63" N	2413.547	1431384	439292.3
121	2018-WTW-10735-OE	99° 49' 32.99" W	36° 11' 43.92" N	2402.305	1429795	440261.5
122	2018-WTW-10736-OE	99° 48' 46.00" W	36° 11' 21.96" N	2432.545	1433604	437969.2
123	2018-WTW-10737-OE	99° 50' 18.02" W	36° 11' 53.02" N	2481.202	1426122	441251.5
124	2018-WTW-10738-OE	99° 50' 32.78" W	36° 11' 54.09" N	2461.997	1424915	441382.7
125	2018-WTW-10739-OE	99° 49' 53.47" W	36° 11' 35.61" N	2471.753	1428101	439453.1
126	2018-WTW-10740-OE	99° 50' 10.19" W	36° 11' 33.62" N	2482.48	1426727	439277.6
127	2018-WTW-10741-OE	99° 50' 32.32" W	36° 11' 36.69" N	2495.883	1424919	439622.3
128	2018-WTW-10742-OE	99° 50' 57.86" W	36° 11' 50.07" N	2396.582	1422852	441015
129	2018-WTW-10743-OE	99° 51' 12.70" W	36° 11' 49.41" N	2399.262	1421634	440970.9
130	2018-WTW-10744-OE	99° 51' 29.76" W	36° 11' 45.55" N	2418.932	1420229	440608.1
131	2018-WTW-10745-OE	99° 51' 42.36" W	36° 11' 55.71" N	2465.35	1419216	441654.5
132	2018-WTW-10746-OE	99° 51' 1.57" W	36° 11' 34.46" N	2431.186	1422518	439442.9
133	2018-WTW-10747-OE	99° 51' 58.07" W	36° 11' 46.25" N	2416.963	1417911	440723.3
134	2018-WTW-10748-OE	99° 42' 32.68" W	36° 10' 54.15" N	2430.723	1464150	434602.8
135	2018-WTW-10749-OE	99° 42' 51.12" W	36° 10' 58.53" N	2432.139	1462647	435072.1
136	2018-WTW-10750-OE	99° 42' 59.03" W	36° 10' 57.52" N	2444.175	1461996	434981.6
137	2018-WTW-10751-OE	99° 43' 7.24" W	36° 10' 55.13" N	2456.866	1461319	434751.3
138	2018-WTW-10752-OE	99° 42' 46.67" W	36° 10' 48.61" N	2442.665	1462993	434062.8
139	2018-WTW-10753-OE	99° 42' 37.36" W	36° 10' 32.55" N	2437.925	1463728	432425.1
140	2018-WTW-10754-OE	99° 42' 52.17" W	36° 10' 28.02" N	2449.154	1462506	431989.1

141	2018-WTW-10755-OE	99° 43' 5.32" W	36° 10' 28.54" N	2465.153	1461429	432060.8
142	2018-WTW-10756-OE	99° 43' 24.34" W	36° 10' 52.40" N	2467.491	1459912	434500.4
143	2018-WTW-10757-OE	99° 43' 36.01" W	36° 11' 1.20" N	2460.302	1458972	435406.9
144	2018-WTW-10758-OE	99° 43' 43.19" W	36° 10' 59.64" N	2456.15	1458380	435259.8
145	2018-WTW-10759-OE	99° 43' 28.72" W	36° 10' 30.91" N	2482.08	1459515	432334.1
146	2018-WTW-10760-OE	99° 43' 58.74" W	36° 10' 49.17" N	2450.839	1457087	434224.3
147	2018-WTW-10761-OE	99° 44' 8.61" W	36° 11' 0.76" N	2461.706	1456299	435409.8
148	2018-WTW-10762-OE	99° 44' 29.10" W	36° 10' 57.29" N	2458.314	1454614	435089
149	2018-WTW-10763-OE	99° 44' 46.60" W	36° 11' 0.27" N	2466.173	1453185	435416.7
150	2018-WTW-10764-OE	99° 45' 3.87" W	36° 10' 55.31" N	2407.682	1451760	434940.7
151	2018-WTW-10765-OE	99° 44' 42.30" W	36° 10' 49.53" N	2462.356	1453518	434323.9
152	2018-WTW-10766-OE	99° 44' 59.08" W	36° 10' 45.85" N	2435.55	1452136	433977.2
153	2018-WTW-10767-OE	99° 45' 11.36" W	36° 10' 38.43" N	2406.502	1451116	433245.2
154	2018-WTW-10768-OE	99° 45' 33.16" W	36° 10' 55.15" N	2427.42	1449359	434968.2
155	2018-WTW-10769-OE	99° 45' 40.56" W	36° 11' 0.78" N	2470.195	1448763	435548
156	2018-WTW-10770-OE	99° 45' 53.70" W	36° 11' 4.10" N	2486.713	1447692	435903.4
157	2018-WTW-10771-OE	99° 46' 1.90" W	36° 10' 56.29" N	2475.051	1447006	435125.8
158	2018-WTW-10772-OE	99° 46' 19.50" W	36° 11' 0.33" N	2441.227	1445570	435560.6
159	2018-WTW-10773-OE	99° 45' 50.26" W	36° 10' 46.85" N	2457.29	1447943	434153.9
160	2018-WTW-10774-OE	99° 45' 39.67" W	36° 10' 33.08" N	2435.891	1448785	432746
161	2018-WTW-10775-OE	99° 46' 10.87" W	36° 10' 40.92" N	2480.433	1446242	433585.3
162	2018-WTW-10776-OE	99° 46' 7.10" W	36° 10' 34.52" N	2464.52	1446540	432932.7
163	2018-WTW-10777-OE	99° 47' 7.92" W	36° 11' 8.01" N	2471.891	1441616	436409.5
164	2018-WTW-10778-OE	99° 47' 22.73" W	36° 11' 1.15" N	2388.605	1440389	435738.7
165	2018-WTW-10779-OE	99° 46' 48.45" W	36° 10' 43.02" N	2451.346	1443166	433854
166	2018-WTW-10780-OE	99° 46' 56.43" W	36° 10' 37.16" N	2485.424	1442501	433273.3
167	2018-WTW-10781-OE	99° 47' 6.00" W	36° 10' 47.43" N	2468.999	1441735	434326
168	2018-WTW-10782-OE	99° 47' 15.69" W	36° 10' 43.22" N	2422.59	1440933	433915.5
169	2018-WTW-10783-OE	99° 47' 51.89" W	36° 10' 51.11" N	2486.213	1437981	434768.1
170	2018-WTW-10784-OE	99° 47' 58.32" W	36° 10' 46.16" N	2497.086	1437445	434277.2
171	2018-WTW-10785-OE	99° 48' 10.94" W	36° 10' 52.56" N	2486.099	1436422	434942.9
172	2018-WTW-10786-OE	99° 48' 23.66" W	36° 10' 59.74" N	2486.9	1435393	435688.9
173	2018-WTW-10787-OE	99° 48' 24.85" W	36° 10' 45.34" N	2496.889	1435269	434234.7
174	2018-WTW-10788-OE	99° 48' 29.43" W	36° 10' 26.60" N	2489.906	1434858	432346.5
175	2018-WTW-10789-OE	99° 48' 47.50" W	36° 10' 28.90" N	2496.876	1433381	432606.7
176	2018-WTW-10790-OE	99° 48' 55.33" W	36° 10' 32.47" N	2485.795	1432746	432980
177	2018-WTW-10791-OE	99° 49' 11.07" W	36° 10' 27.21" N	2496.672	1431446	432472
178	2018-WTW-10792-OE	99° 49' 33.34" W	36° 10' 34.88" N	2497.171	1429635	433281.7
179	2018-WTW-10793-OE	99° 49' 53.27" W	36° 10' 38.41" N	2485.918	1428008	433669.5
180	2018-WTW-10794-OE	99° 50' 3.92" W	36° 10' 38.77" N	2484.771	1427136	433722.2
181	2018-WTW-10795-OE	99° 50' 17.02" W	36° 10' 43.06" N	2497.882	1426070	434176.2
182	2018-WTW-10796-OE	99° 50' 26.33" W	36° 10' 40.85" N	2490.85	1425303	433967.8
183	2018-WTW-10797-OE	99° 50' 34.12" W	36° 10' 40.05" N	2496.924	1424663	433898.7
184	2018-WTW-10798-OE	99° 51' 10.46" W	36° 10' 51.20" N	2496.026	1421706	435082.6
185	2018-WTW-10799-OE	99° 51' 31.86" W	36° 10' 54.28" N	2486.54	1419958	435427.3
186	2018-WTW-10800-OE	99° 51' 59.60" W	36° 10' 51.78" N	2461.786	1417679	435218.6
187	2018-WTW-10801-OE	99° 52' 19.40" W	36° 10' 51.09" N	2451.843	1416055	435180.4

188	2018-WTW-10802-OE	99° 43' 45.56" W	36° 10' 2.87" N	2482.001	1458084	429524
189	2018-WTW-10803-OE	99° 43' 58.58" W	36° 10' 9.30" N	2484.019	1457028	430193.1
190	2018-WTW-10804-OE	99° 44' 11.85" W	36° 10' 9.45" N	2475.558	1455941	430227.2
191	2018-WTW-10805-OE	99° 43' 54.97" W	36° 9' 45.50" N	2479.987	1457282	427781.4
192	2018-WTW-10806-OE	99° 44' 7.80" W	36° 9' 48.93" N	2482.841	1456236	428146.6
193	2018-WTW-10807-OE	99° 44' 27.31" W	36° 10' 11.07" N	2460.611	1454676	430413.9
194	2018-WTW-10808-OE	99° 44' 41.98" W	36° 10' 11.66" N	2434.78	1453475	430494.8
195	2018-WTW-10809-OE	99° 45' 8.46" W	36° 10' 16.60" N	2435.461	1451314	431033.7
196	2018-WTW-10810-OE	99° 45' 21.77" W	36° 10' 14.84" N	2408.584	1450219	430875.8
197	2018-WTW-10811-OE	99° 44' 56.86" W	36° 10' 4.78" N	2441.152	1452243	429821.8
198	2018-WTW-10812-OE	99° 44' 28.34" W	36° 9' 46.12" N	2488.397	1454547	427893.2
199	2018-WTW-10813-OE	99° 44' 42.48" W	36° 9' 49.08" N	2473.679	1453393	428212.8
203	2018-WTW-10817-OE	99° 46' 4.31" W	36° 10' 11.85" N	2440.285	1446726	430636.9
204	2018-WTW-10818-OE	99° 46' 17.27" W	36° 10' 6.96" N	2451.244	1445655	430161.7
208	2018-WTW-10822-OE	99° 47' 26.83" W	36° 10' 6.47" N	2497.031	1439952	430216
209	2018-WTW-10823-OE	99° 47' 42.41" W	36° 9' 52.02" N	2490.839	1438648	428778.8
210	2018-WTW-10824-OE	99° 48' 3.46" W	36° 9' 38.37" N	2497.121	1436896	427431.5
211	2018-WTW-10825-OE	99° 48' 26.78" W	36° 9' 52.57" N	2497.564	1435011	428902.2
212	2018-WTW-10826-OE	99° 48' 58.33" W	36° 10' 17.48" N	2485.797	1432472	431468.9
223	2018-WTW-10837-OE	99° 43' 29.78" W	36° 9' 26.22" N	2468.185	1459312	425795.3
224	2018-WTW-10838-OE	99° 43' 45.04" W	36° 9' 20.31" N	2470.82	1458050	425220.4
225	2018-WTW-10839-OE	99° 43' 58.07" W	36° 9' 19.49" N	2472.045	1456981	425155.9
226	2018-WTW-10840-OE	99° 44' 10.15" W	36° 9' 16.29" N	2480.382	1455984	424849.9



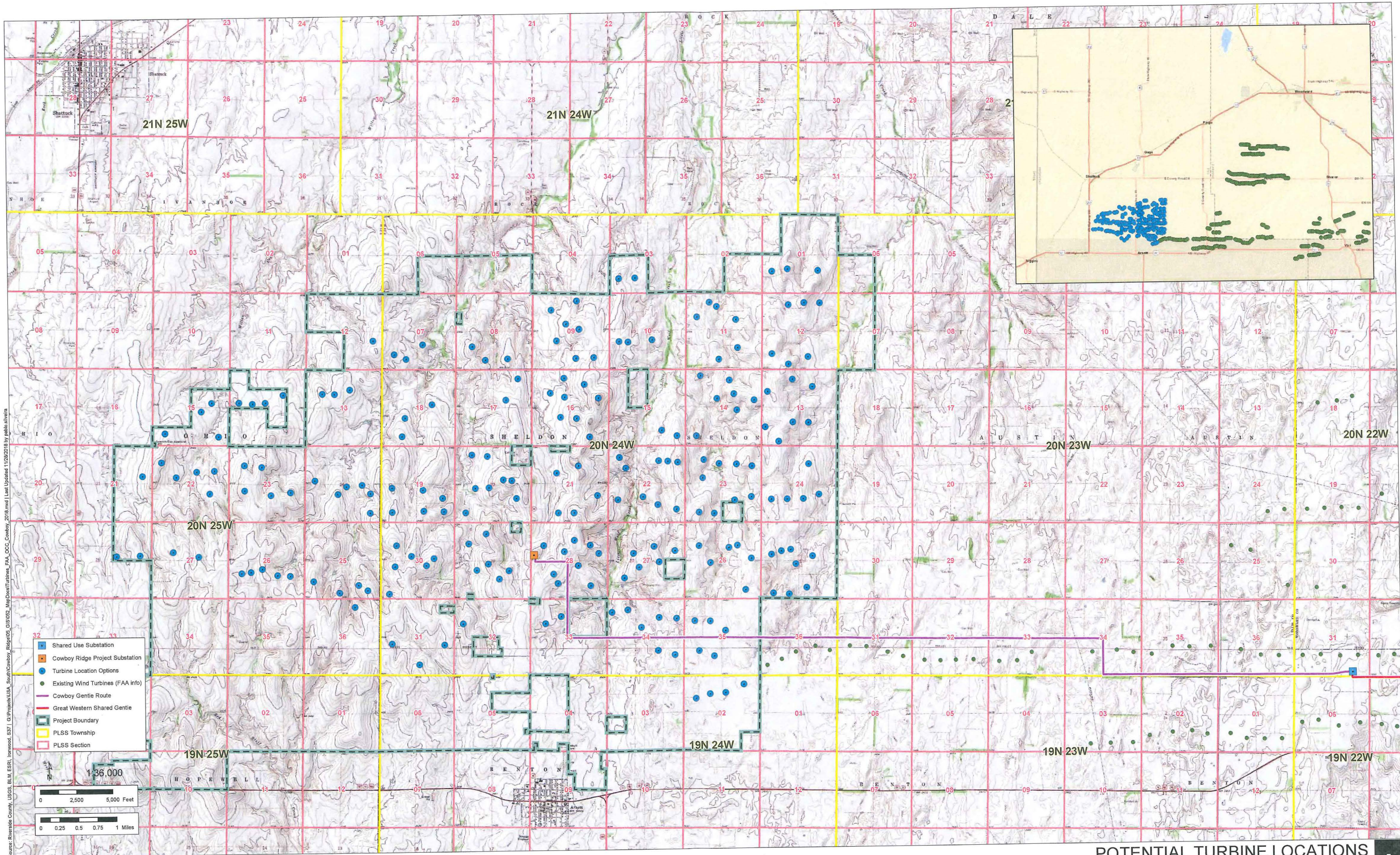

Source: Riverside County, UEGIS, BLM, ESR, Ironwood, SST | G:\Projects\USA\_South\Cowboy\_Ridge\05\_GIS\05\_MapDocs\Turbines\_FAA\_OCC\_Cowboy\_2018.mxd | Last Updated: 11/28/2018 by gabbalvarez

- Shared Use Substation
- Cowboy Ridge Project Substation
- Turbine Location Options
- Existing Wind Turbines (FAA info)
- Cowboy Gentle Route
- Great Western Shared Gentle
- Project Boundary
- PLSS Township
- PLSS Section

**POTENTIAL TURBINE LOCATIONS**  
Cowboy Ridge Wind Energy Project | Ellis County, Oklahoma



Exhibit B