



Oklahoma Department of Transportation

Environmental Programs Division

Office 521-3050 Fax 522-5193

Programmatic/Individual Categorical Exclusion

<input checked="" type="checkbox"/> X	PCE	<input type="checkbox"/>	ICE
---------------------------------------	-----	--------------------------	-----

Date	August 8, 2016	Project Number	STP-175C(093)
County	Washita	State Job Piece No:	24352(10)
NEPA Project Manager	Judy Dennis	Phone Number	(405)521-2321
ODOT Field Division	5	Bridge NBI No. <i>(For County & State Projects)</i> & Location No. <i>(County Projects Only)</i>	01848
Project Description from JPINFO	Widen, Resurface and Bridge on SH-152 from 5.8 mile east of the Beckham County Line east 5.0 miles		
This project is included in: <i>(Check all applicable ones)</i>	<input checked="" type="checkbox"/> X	State 8 Year Construction Program	
	<input type="checkbox"/>	County 5 Year Construction Program	
	<input type="checkbox"/>	State Transportation Improvement Program	
This project is in the Metropolitan Transportation Improvement Program (If applicable) <i>(Check applicable one)</i>	<input type="checkbox"/>	YES	
	<input checked="" type="checkbox"/> X	NOT APPLICABLE	

The Oklahoma Department of Transportation (ODOT) has completed the environmental analysis and review of the referenced project. ODOT has determined that this project does not individually or cumulatively have a significant impact of the environment as defined by the National Environmental Policy Act (NEPA) or involve unusual circumstances as defined in 23 CFR 771.117(b) and is therefore excluded from the requirements to prepare an Environmental Assessment or Environmental Impact Assessment.

Existing Conditions <i>(Describe existing bridge width, approach roadway width, etc., traffic (current and projected), Existing Problems such as sufficiency rating):</i>
The existing SH-152 roadway consists of 2 – 12 ft. wide driving lanes and 1 ft. paved shoulders. The existing Bridge “A”, NBI No. 01848, over Unnamed Creek is a 38 ft. long Reinforced Concrete Box (RCB) and has a sufficiency rating of 87.1. The current Annual Average Daily Traffic (AADT) is 2,100 vehicles per day (vpd) and a future AADT of 3,400.
Purpose & Need <i>(Why the project is needed such as structural deficiency or bridge does not meet current state/federal standards for width or vertical clearance or the roadway has sharp horizontal curves or sight distance problems or narrow shoulders which do not meet current standards):</i>
The purpose and need for the project is to improve a narrow roadway.

Alternatives considered & Proposed Improvement (Provide reason why an offset alignment to one side is selected vs the other side, Proposed construction such as roadway and bridge widths, AND mention whether the road will be open to traffic during construction.):

The proposed improvements consist of widening and overlaying the existing roadway to 40 ft. wide with 2 12 ft. driving lanes and 8 ft. shoulders. The existing Bridge "A" will be lengthened to 84.92 ft. to meet clear zone requirements. The road will stay open to local and through traffic during construction.

Did the project have public involvement (Check the applicable items and include public involvement summary and supporting documents in the appendix)

<input checked="" type="checkbox"/>	Property Owner Notification	<input type="checkbox"/>	Road Closure Letter	<input type="checkbox"/>	Public/Stakeholder Meeting
	Legal Notice/Website Posting	<input type="checkbox"/>	Small City Letter	<input type="checkbox"/>	None

All documentation, analyses, and agency coordination regarding this Categorical Exclusion are attached to this document and maintained in the project file at the Oklahoma Department of Transportation, Environmental Programs Division.

Criteria Identified in Section III.b.3. of the 2011 FHWA/ODOT Programmatic Agreement for Processing Categorical Exclusions that would require Individual Review and Approval by FHWA:

Check Yes or No below. If the answer to any of the questions below is Yes, an Individual CE will be required.

Description/Question	Yes	No
Item(a)		
1. Does the project involve residential or commercial relocation?		<input checked="" type="checkbox"/>
2. Does the project involve acquisition of right-of-way not adjacent to the existing facility?		<input checked="" type="checkbox"/>
3. Does the project involve property in which another Federal Agency or Federally Recognized Tribe has ownership, oversight or any other encumbrance?		<input checked="" type="checkbox"/>
Item(b)		
Does the project involve a determination of adverse effect by Oklahoma State Preservation Office (SHPO) or a designated Tribal Historic Preservation (THPO) in accordance with Section 106? An exception to this would apply if adverse effects are addressed programmatically as part of a previously executed general Section 106 Programmatic Agreement with SHPO, FHWA and others, and a project-specific MOA will not be required.		<input checked="" type="checkbox"/>
Item (c)		
Does the project involve a Programmatic Section 4(f) or <i>de minimis</i> finding which has not been previously approved by FHWA?		<input checked="" type="checkbox"/>
Item (d)		
Does the project involve a Section 6(f) property?		<input checked="" type="checkbox"/>
Item (e)		
Does the project involve any impact on Noise Abatement Criteria (NAC) Category A, B, C or D receptors?		<input checked="" type="checkbox"/>
Item (f)		
1. Does the project involve a finding of "may effect, likely to adversely affect" to a federally listed endangered or threatened species or its critical habitat determined during the Section 7 Informal Consultation Process? The exception to this is the American Burying Beetle or any other species which has been addressed under a separate formal programmatic agreement.		<input checked="" type="checkbox"/>
2. Does the project involve a Section 7 Formal Consultation Process?		<input checked="" type="checkbox"/>
Item (g)		
Does the project require an Individual Section 404 Permit (This is for major River Crossings, waters or wetlands impact greater than 0.5 AC, Projects with Formal Consultation, or others as determined by USACE)?		<input checked="" type="checkbox"/>

Criteria Identified in Section III.b.3. of the 2011 FHWA/ODOT Programmatic Agreement for Processing Categorical Exclusions that would require Individual Review and Approval by FHWA:
Check Yes or No below. If the answer to any of the questions below is Yes, an Individual CE will be required.

Description/Question	Yes	No
Item (h)		
Does the project require a Coast Guard Permit?		X
Item (i)		
Does the project involve construction across or adjacent to a river designated as a component in the National System of Wild and Scenic Rivers?		X
Item (j)		
Does the project involve an adverse impact on prime farmland where Natural Resources Conservation Agency (NRCS) has required consideration of alternatives and measures to avoid and minimize impacts?		X
Item (k)		
Does the project involve increase to the base 100 Year floodplain in a regulatory floodway (Zone A-E in a FEMA Map) that will require a flood map revision as determined by the appropriate state or local authority?		X
Item (l)		
Does the project involve any known Superfund site?		X
Item (m)		
Does the project involve any permanent changes to the operation of an Interstate highway, associated interchanges or ramps?		X
Item (n)		
Does the project have potential for disproportionately high and adverse impact on minority or low income populations, based on known demographics in the project vicinity, extent of R/W, relocations, and other identified impacts?		X
Item (o)		
Does the project have any substantial or public controversy on environmental grounds?		X
Item (p)		
If the project involves road closure or ramp closure, do any of the following conditions apply? <i>(Check the boxes ONLY if the project involves road closure)</i>		
i. No Access will be provided to local traffic or posted		
ii. Through traffic dependent businesses will be affected		
iii. The detour closure will interfere with special events or activities		
iv. The detour or closure will substantially alter the environmental consequences of the action, such as by creating unsafe conditions on the detour route or requiring additional work or expansion to detour routes to carry the additional traffic.		
v. There is a public controversy associated with the detour or closure		
Explanation for Individual CE (If any of the answers above are YES):		
Item for which the answer is YES		
Explanation that CE Classification is appropriate		
Item for which the answer is YES		
Explanation that CE Classification is appropriate		

Commitments (<i>Check Applicable ones</i>)	
	Plan notes requiring avoidance of cultural resources in off-project areas will be added to the final project plans under “Environmental Mitigation Notes” per policy Directive C-201-2D(2).
	Properties eligible for the National Register of Historic Places (NRHP) have been identified within the project area. Plans need to be submitted to Environmental Programs Division by the Designer for further coordination with the State Historic Preservation Office (SHPO) prior to the bid solicitation process or construction.
	Properties eligible for the National Register of Historic Places (NRHP) have been identified within the project area. The State Historic Preservation Office (SHPO)’s approval is based on the project as currently proposed. The following Plan notes will be added to the final project plans under “Environmental Mitigation Notes” per policy Directive C-201-2D(2). Properties eligible for the National Register of Historic Places (NRHP) have been identified within the project area. The State Historic Preservation Office (SHPO)’s approval is based on the project as currently proposed. If there are any changes to the project plans, further coordination with the SHPO will be required through the Environmental Programs Division prior to the bid solicitation process or field changes during construction.
	(Only for Special Projects) Properties eligible for the National Register of Historic Places (NRHP) have been identified within the project area. Further coordination with the State Historic Preservation Office (SHPO) is required by the ODOT Project Management’s Special Projects Branch prior to the bid solicitation process or construction. The SHPO letter which cites the information needed to proceed is included in the Appendix. The file number from the SHPO letter should be referenced in all correspondence with SHPO. Copies of such coordination should be provided to the Environmental Programs Division for the project record.
	(Only for Special Projects) Properties eligible for the National Register of Historic Places (NRHP) have been identified within the project area. The State Historic Preservation Office (SHPO)’s approval is based on the project as currently proposed. The following Plan notes will be added to the final project plans under “Environmental Mitigation Notes” per policy Directive C-201-2D(2). If there are any changes to the project plans, further coordination with the SHPO will be required by the ODOT Project Management’s Special Projects Branch prior to the bid solicitation process or field changes during construction. Please reference the SHPO letter which cites the conditions of approval and reference the file number from SHPO letter in all correspondence. Copies of such coordination should be provided to the Environmental Programs Division for the project record.
	The project occurs in an area where the American burying beetle (ABB) occurs. Special Provision 656-4 for ABB will be added to the final project plans/contract per policy Directive C-201-2D(2).
	Survey for the following species need to be completed prior to constructions and plan notes will be provided after the completion of the survey(<i>List species survey requirements below</i>)
	Plan notes requiring construction season restrictions for the following species will be added to the final project plans under “Environmental Mitigation Notes” per policy Directive C-201-2D(2). (<i>List species or notes below</i>)
	Plan notes requiring avoidance and minimization of impacts for the following species will be added to the final project plans under “Environmental Mitigation Notes” per policy Directive C-201-2D(2). (<i>List species below</i>)
	The following Plan notes requiring construction season restrictions for the migratory birds will be added to the final project plans under “Environmental Mitigation Notes” per policy Directive C-201-2D(2). <u>Migratory Bird Notes</u> X Migratory birds are protected by the federal Migratory Bird Treaty Act. These birds commonly use bridges and culverts for nesting. The nesting season for the birds runs from April 1 to August 31. Any activities which would destroy active nests or harm eggs or birds would violate the Migratory Bird Treaty Act. Migratory bird use of bridge NBI No. 01848 also culvert at Sta. 394+41.12, Sta.

Commitments (<i>Check Applicable ones</i>)	
	539+31.41, and Sta. 555+88.98 has been observed during the initial survey conducted as part of the biological studies in 2016. Migratory bird use of the remaining bridges and culverts was not observed during the initial survey. Migratory birds may occupy these structures in the future nesting seasons. The Resident Engineer will evaluate the contractor's proposed work methods and conclude whether the proposed work would pose disruption to any nesting birds before work near the structure is authorized. If the proposed work will harm any nesting birds, the bridge may be netted prior to April 1 or the work delayed until the nesting season is complete. Methods other than netting must be pre-approved by the ODOT Biologist.
X	The action may involve work in potentially jurisdictional waters and potentially jurisdictional wetlands. For State Projects, the 404 permit application form needs to be submitted by the Designer through Project Management Division to Environmental Programs Division at the time of Right-of-Way submittal for evaluation and determination of the appropriate Clean Water Act Section 404 permit application for the project. For Local Government Projects or Special Projects, a copy of the 404 permit obtained by the County/City should be submitted by Local Government Division or Special Projects to Environmental Programs Division for the Project File.
	The action involves work in Critical Resource Waters and requires Pre Construction Notification (PCN) to USACE regardless of the area of impact. For Local Government Projects or Special Projects, a copy of the PCN by the County should be submitted by Local Government Division or Special Projects Branch to Environmental Programs Division for the Project File.
	The action will require a FEMA Map revision.
	Plan notes requiring avoidance of potential hazardous materials remains areas will be added to the final project plans under "Environmental Mitigation Notes" per policy Directive C-201-2D(2).
	The Department's Hazardous Coordinator has determined that a Preliminary Site Investigation (PSI) is required for this project. Construction Plans need to be submitted by the Designer to Environmental Programs Division at the time of Right-of-Way submittal for the PSI.
	The following plan note regarding Road Closure will be added to the plans
	The roadway will be closed to traffic during construction. The County or City will be responsible for notifying all local residential and commercial property owners, schools, and emergency services providers prior to construction. The County or City will be responsible for posting the detour routes. The Contractor will provide access to local property owners at all times during construction.
	<i>(Only for Local Government Projects)</i> The Local Government Project Manager shall coordinate any required species surveys with Environmental Programs Division prior to letting the project. Note the seasonal restrictions for surveys in the biological studies summary.
X	The following Airport/Airfield located within 4 miles of this project. This action may require notifying the Federal Aviation Administration (FAA) of proposed construction via FAA Form 7460-1 prior to construction. (<i>List the name of the Airport below</i>)
	Clinton-Sherman Industrial Airpark
	Other (<i>List Commitment below</i>)
	Other (<i>List Commitment below</i>)

The mitigation measures above should be discussed at all Pre-work conferences per Policy Directive C-201-2E(1). The Designer shall provide a **copy of the final plans with the mitigation notes** to Environmental Programs Division for the project Records.

Development of the project including coordination and assessment of potential social, economic and environmental impacts has been considered in accordance with DOT ORDER 5610.1C, and CEQ REGULATIONS 40 CFR 1500 -1508 as amended, 23 CFR 771.117 and the 2011 FHWA/ODOT Programmatic Agreement for processing of categorical exclusions. Implementation of this action as a "Categorical Exclusion" will satisfy the requirements of the National Environmental Policy Act.

Preparer/Reviewer Signatures

N/A		
Environmental Consultant Project Manager (If Applicable)	Date	
N/A		
Environmental Consultant Firm Name (If Applicable)	Date	
N/A		
County Commissioner or City Manager (For Local Government Projects)	Date	
<i>Judy Dennis</i> ODOT Environmental Project Manager	8/8/16	
<i>Kevin M. Lavoie</i> for Assistant Environmental Programs Division Engineer	8/10/2016	
<i>Kevin M. Lavoie</i> for Environmental Programs Division Engineer	8/10/2016	
CONCLUSION:		
ODOT has reviewed the conditions identified in Section IIIb.3 of Federal Highway Administration (FHWA)/ODOT Programmatic Agreement for Processing Categorical Exclusions (CE) and determined that an Individual CE must be submitted to FHWA for approval.		YES
	X	NO

For Individual CEs requiring FHWA Approval:

Concurrence that this project qualifies for a Categorical Exclusion:

N/A	
Environmental Programs Manager, FHWA	Date

- Attachments:
- Location Map
 - Memos with Plan Notes
 - NEPA On Hold Memo if applicable
 - Plans and Footprint
 - Studies
 - NEPA Status Report

Distribution List (Check Applicable Ones)

X	Project Management Division (All State Projects)
X	Roadway Design Division (All State projects with the exception of projects from Traffic Division and Special Projects)
X	Bridge Division (All State Bridge Projects)
	Traffic Division (For projects from Traffic Division)
	Local Government Division (County or City Projects)
	Special Projects (Special Projects Only)
	Safe Routes to School Coordinator (SRTS Projects Only)
X	Field Division Engineer (All Projects)
X	Right-of-Way Division (All Projects)
X	Office Engineer Division (All Projects)
X	FHWA (All Projects. Place Copy of Complete Document on FHWA's Directory)

Copy to: Reading File

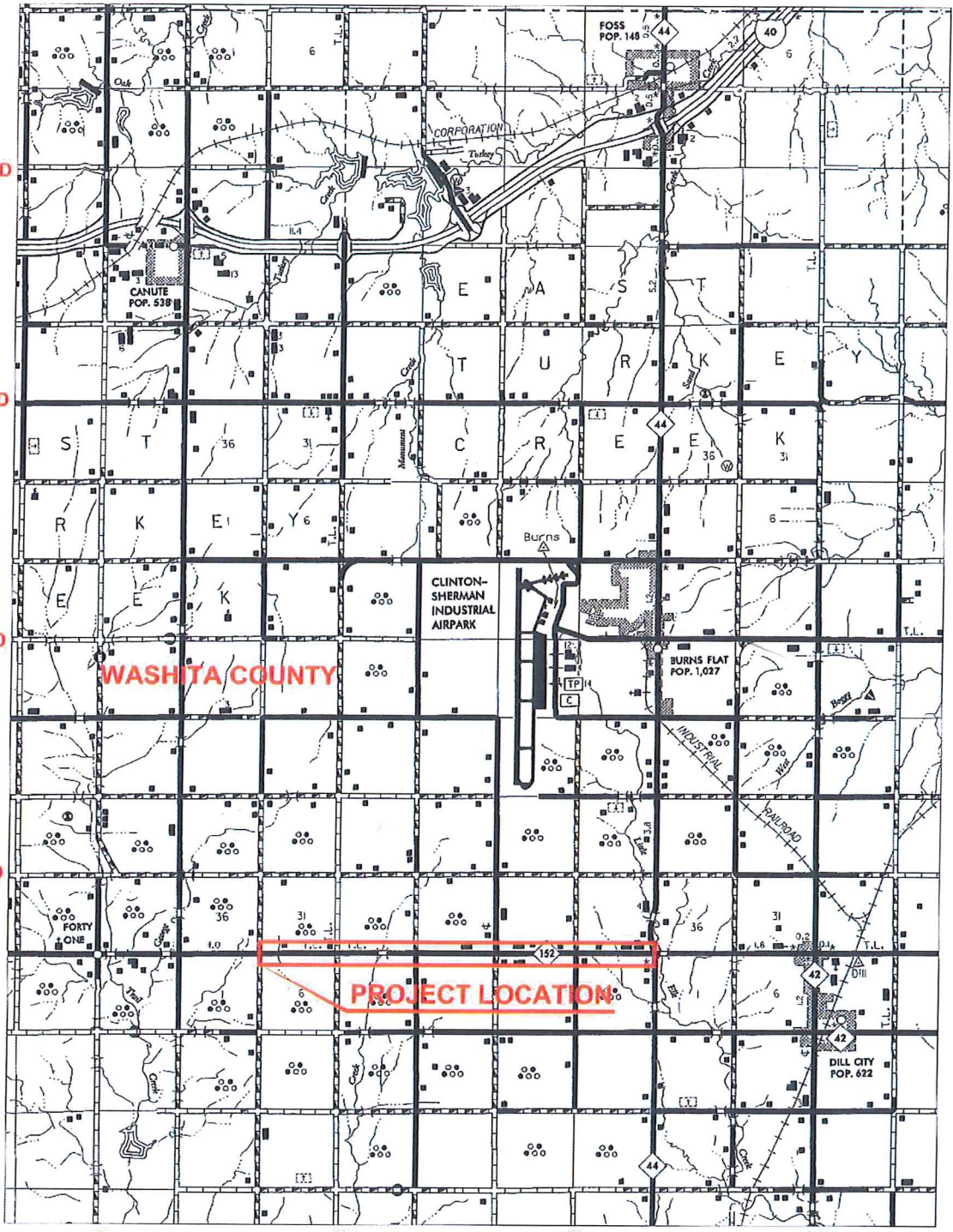

EW 109 RD

EW 112 RD

EW 115 RD

EW 118 RD

EW 121 RD

NS 207 RD

NS 210 RD

NS 213 RD

NS 216 RD

WASHITA COUNTY

PROJECT LOCATION

WASHITA COUNTY

JP 24352(10)

SH-152





Oklahoma Department of Transportation

Environmental Programs Division

Office 521-3050 Fax 522-5193

DATE: March 14, 2014

TO: Project Management Division

FROM: Judy Dennis, Environmental Programs Division *JDD*

SUBJECT: Notification of NEPA on Hold

County	Washita	State Job Piece No:	24352(10)
NEPA Project Manager	Judy Dennis	Phone Number	(405)522-0734
ODOT Field Division	5	Bridge NBI No. (For County & State Projects) & Location No. (County Projects Only)	01848
Project Description from JPINFO (Type of Construction & Project Extent)	Widen, Resurface and Bridge on SH-152 from 6.0 miles east of the Beckham County Line east 5.0 miles		
Let Date	2019		

Preliminary environmental studies have been completed for the above referenced project with the exception of the studies which require 30% plans before they can be completed.

Check applicable items

The NEPA process is on hold until the availability of 30% plans to complete some of the studies. Additional 2 to 6 months will be required to complete these studies.

The NEPA process is on hold until the availability of 60% plans showing proposed final right-of-way. NEPA Document will be completed within 60 days of receipt of plans if the plans fall within the study footprint. Otherwise, additional time will be required to update the studies. Also, additional 60 days will be required if the plans show any potential Relocations.

Copy to: Director of Engineering – Tim Tegeler
 Engineering Manager, Roadway Design
 Engineering Manager, Bridge Design
 Field Division Engineer
 Right-of-Way Division

JDD