



The Oklahoma Department of Transportation invites you to a  
**PUBLIC OPEN HOUSE**  
to solicit public and agency input on the proposed  
improvements to SH-66 from Depew to Bristow • JP 28890(04)

Public Open House  
on Proposed  
Improvements  
to SH-66 from  
Depew to Bristow

**NEW DATE:**  
**Tuesday**  
**April 17, 2018**  
**5:30-7:30pm**  
**Come & Go Format**

Bristow Public Library  
111 W. 7th Ave.  
Bristow, OK 74010

## PROJECT

The Oklahoma Department of Transportation (ODOT), in cooperation with the Federal Highway Administration (FHWA) is improving a segment of SH-66 between Depew and Bristow in Creek County. This segment begins approximately 1.5 miles east of Depew, Oklahoma at the intersection of SH-66 and S. 433rd W. Avenue and extends east approximately 4.2 miles to the intersection of SH-66 and S. 369th W. Avenue in Bristow, Oklahoma (see Location Map on reverse). The existing highway through this extent has inadequate shoulders, sharp curves, and steep hills, which result in limited sight distance and unsafe conditions.

## PURPOSE

The purpose of the project is to improve the safety of a segment of roadway with no shoulders and correct unsafe curves and intersections.

## TOPICS

- Project Purpose and Need
- Proposed Improvements
- Estimated Cost
- Right-of-Way, Utility & Environmental Impacts

ODOT sincerely appreciates your cooperation in this matter. Should you have any questions regarding the project, please contact David Saulsbury, ODOT Division 8 Environmental Program Manager at 405.521.2315 or dsaulsbury@odot.org; or please contact ODOT's authorized agent Jared Bechtol with CEC Corporation at 405.753.4200 or jared.bechtoll@connectcec.com.

*The Oklahoma Department of Transportation (ODOT) ensures that no person or groups of persons shall, on the grounds of race, color, sex, religion, national origin, age, disability, retaliation or genetic information, be excluded from participation in, be denied the benefits of, or be otherwise subjected to discrimination under any and all programs, services, or activities administered by ODOT, its recipients, sub-recipients, and contractors. To request an accommodation please contact the ADA Coordinator at 405-521-4140 or the Oklahoma Relay Service at 1-800-722-0353. If you have any ADA or Title VI questions email ODOT-ada-titlevi@odot.org.*



Oklahoma Department of Transportation  
Environmental Programs Division  
200 N.E. 21<sup>st</sup> St.  
Oklahoma City, OK 73105  
405.521.3050  
[odot.org](http://odot.org)



**CEC**

CEC Corporation  
4555 W. Memorial Rd.  
Oklahoma City, OK 73142  
405.753.4200  
[info@connectcec.com](mailto:info@connectcec.com)  
[connectcec.com](http://connectcec.com)

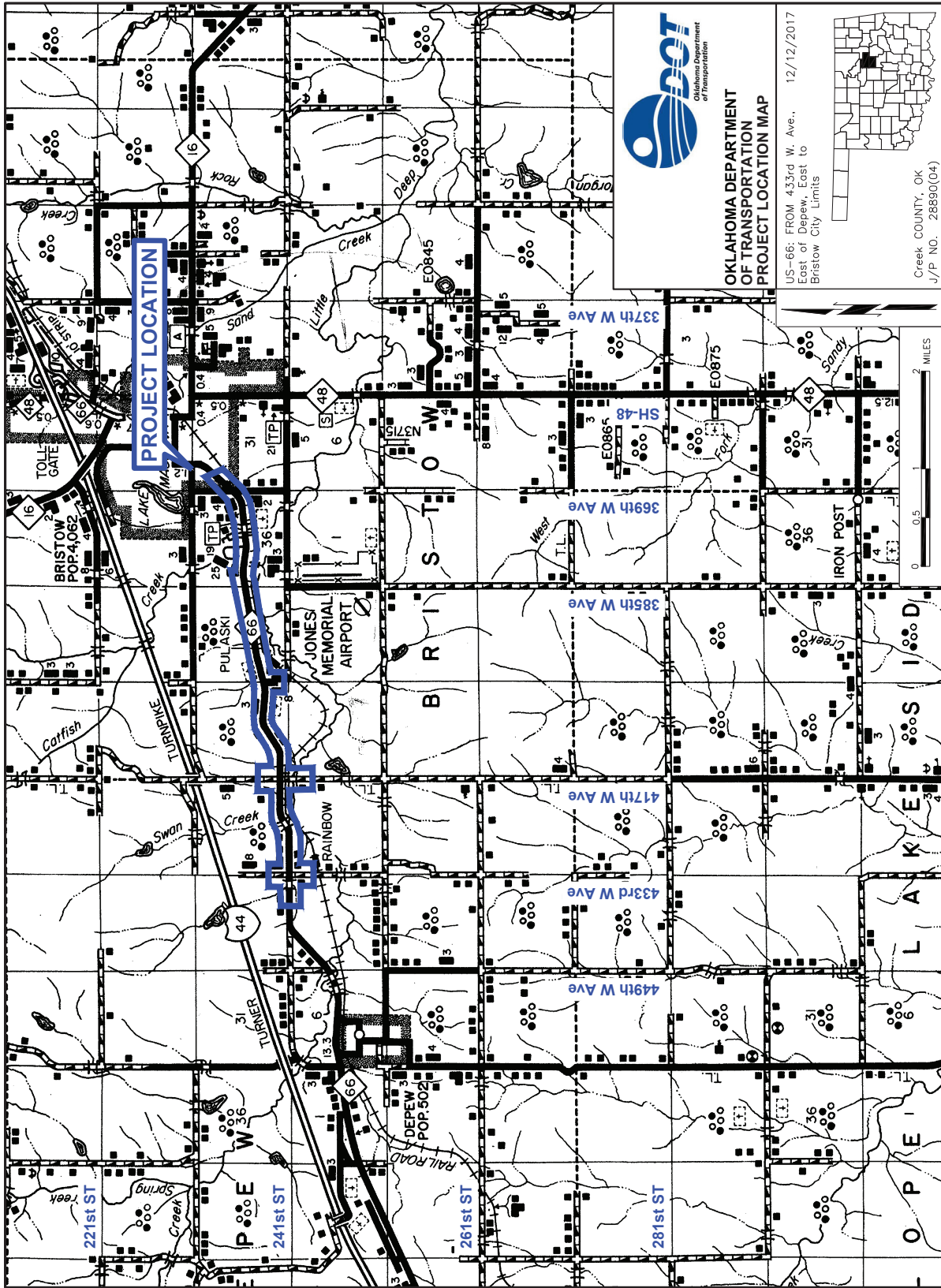

**OKLAHOMA DEPARTMENT  
OF TRANSPORTATION  
PROJECT LOCATION MAP**

US-66: FROM 433rd W. Ave.,  
East of Depew, East to  
Bristow City Limits

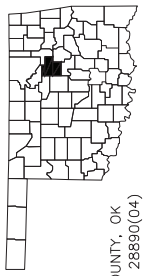

Creek County, OK  
J/P NO. 28890(04)



Oklahoma Department of Transportation  
Environmental Programs Division  
200 N.E. 21st St.  
Oklahoma City, OK 73105  
405.521.3050  
odot.org



**CEC**

CEC Corporation  
4555 W. Memorial Rd.  
Oklahoma City, OK 73142  
405.753.4200  
info@connectcec.com  
connectcec.com

<http://www.odot.org/publicmeetings>

