

PLEASE PROVIDE YOUR COMMENTS BY MAY 31, 2023

For more information about the project:
(405) 325-3269 | environment@odot.org

PROJECT INFORMATION SUMMARY

- Design: 2023
- Construction Scheduled To Begin: 2024
- Currently Programmed Cost: \$35 Million

*Schedule is contingent on funding and subject to change

DISTRICT 2 ENGINEER: ANTHONY ECHELLE, P.E.

*Totals DO NOT include Toll Roads

***Total Road Miles**
1,649.55

**Totals DO NOT include County Bridges

****Total Bridges**
873

COUNTIES

Atoka, Bryan, Choctaw, Latimer, LeFlore, **McCurtain**,
Marshall, Pittsburg, Pushmataha

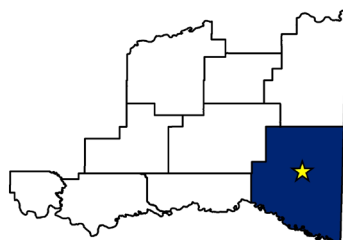

Public Meeting

Tuesday, May 16, 2023

**US-259 FROM 6.25 MILES NORTH OF SH-3
JUNCTION EXTENDING NORTH 6 MILES**

McCurtain County; JP 34333(04)

Tuesday, May 16, 2023

Crystal Forest Venue

263 Crooked Oak Ln., Broken Bow, OK 74728

5:30 pm - 7:30 pm

AGENDA

5:30 pm - 6:00 pm Receive Handout

6:00 pm - 6:30 pm Presentation

6:30 pm - 7:30 pm Project Questions and Provide Comments



PUBLIC MEETING PURPOSE

The purpose of the Public Meeting is to inform the community about the proposed US-259 project, the design alternatives, and to provide an opportunity to submit comments prior to the detailed design phase for the project.



CORRIDOR SIGNIFICANCE

This segment of US-259 is adjacent to properties owned by the U.S. Forest Service, Ouachita National Forest, Choctaw Nation of Oklahoma, as well as private retail and rental businesses. Beavers Bend State Park and Broken Bow Lake are also major tourist attractions to this quickly growing community. Traffic continually increases each year, which causes associated traffic congestion (quality of life and environmental concerns) and safety issues. ODOT completed a Reconnaissance Data Collection Report for this scenic corridor in 2021. Initial environmental reviews have been performed to assess the potential for impacts to natural and cultural resources, and additional environmental reviews will take place during project design. Furthermore, roadway and traffic safety improvements will be part of the design of the ultimate configuration.



www.odot.org/publicmeetings

Project Overview

The purpose of this US-259 project is to increase the safety and operation along the highway. The existing segment of US-259 consists primarily of 2-lanes with variable shoulders and pavement conditions showing deterioration. The state highway system in and around the Broken Bow/Hochatown area is not functioning in a way that serves the current needs, and especially, the future needs of an ever-changing region. ODOT will build and maintain the existing highway to better accommodate those needs while remaining sensitive to the goals of the local community.

In 2022, traffic intersection modifications were implemented to improve the safety and operation along the project area. With the current and upcoming growth in this area, the intent of this project is to improve the roadway to alleviate traffic congestion.

Design Alternatives

There are two design configurations being considered, which include a 3-lane configuration and a 5-lane configuration.

3-Lane Configuration

This design alternative consists of one driving lane in each direction with a center turn lane in the middle. The outside of the driving lanes will have shoulders in the rural sections and may have curb and gutter in the more urban sections.

5-Lane Configuration

This design alternative consists of two driving lanes in each direction and possibly a center turn lane in the middle. The outside of the driving lanes will have shoulders in the rural sections and may have curb and gutter in the more urban sections.

Project Schedule



*Schedule is contingent on funding and subject to change

TYPICAL SECTIONS

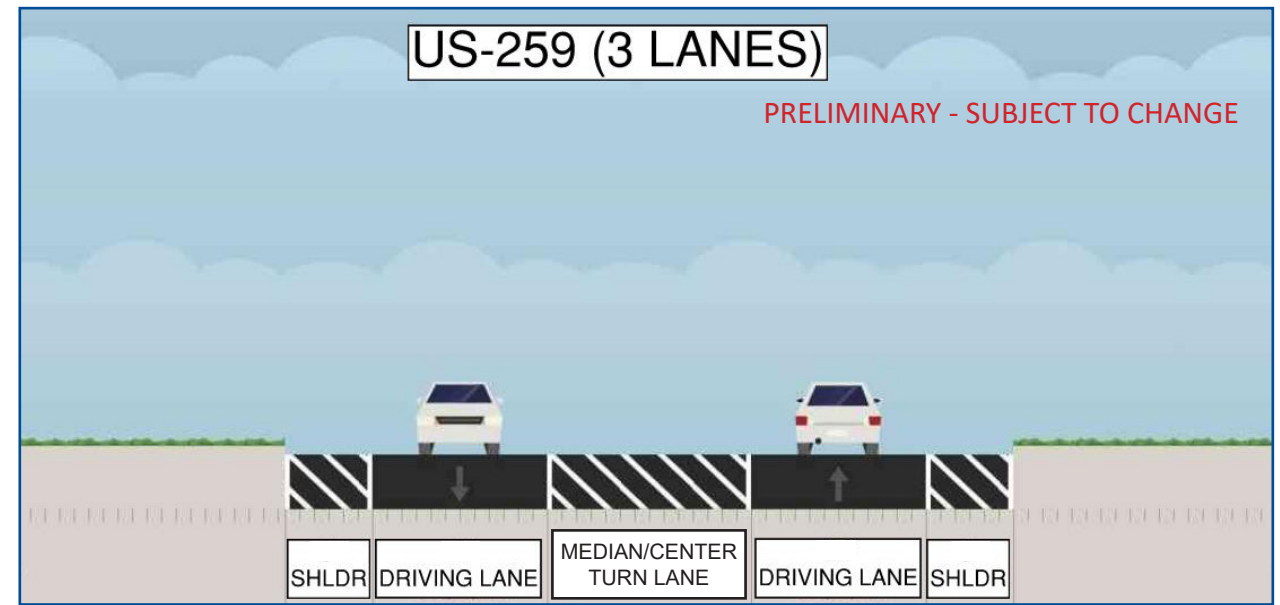

Typical 3-lane section

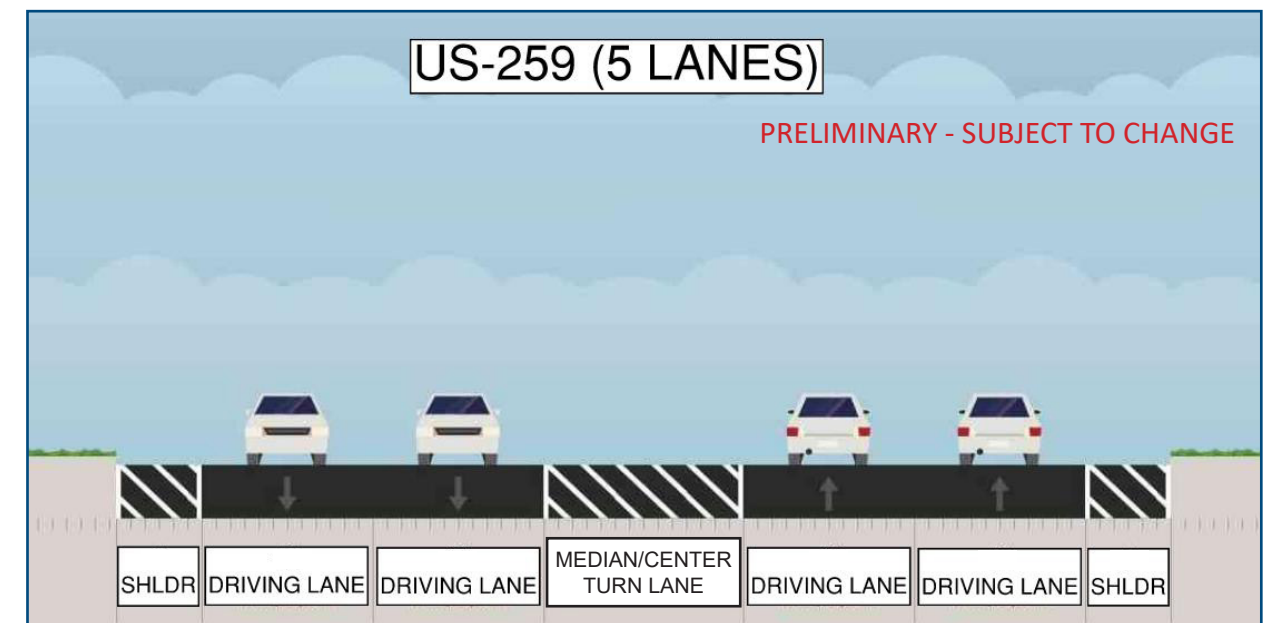

Typical 5-lane section



OKLAHOMA Transportation

FREQUENTLY ASKED QUESTIONS (FAQ)

US-259 From 6.25 Miles North of SH-3 Junction Extending North 6 Miles

- Q:** Where is the proposed project located?
A: *The proposed US-259 project is within the Hochatown area. A future US-259 project will extend improvements further south (from approximately SH-259A South to SH-3 Junction), which is scheduled to occur after the proposed project.*
- Q:** Why is the proposed project near Hochatown scheduled to occur before the future US-259 project?
A: *The traffic congestion and need for improvements in the Hochatown area are more severe than the area further south, so ODOT has prioritized completing the proposed improvements near Hochatown.*
- Q:** Will both lane configurations being considered for the proposed project be compatible with the potential lane configuration of the future project?
A: *The two different lane configurations being considered for this project (3-lane or 5-lane configurations) would both be compatible with potential configurations of the future project.*
- Q:** Will the proposed US-259 road improvements include new sidewalks/trails?
A: *The community provided feedback wanting additional transportation options like sidewalks or trails. As such, ODOT is proposing to include sidewalks/trails for certain segments of this project.*
- Q:** Will the proposed road and sidewalk/trail improvements stay within ODOT right-of-way for both configurations?
A: *The intention for either the 3-lane configuration or the 5-lane configuration is for the proposed roadway and sidewalk/trail improvements to stay within ODOT right-of-way. Detailed design is needed before confirming the outer limits of construction.*
- Q:** How will traffic be impacted during construction? Will the road be closed during construction?
A: *Traffic along US-259 is proposed to be maintained during construction. Travelers may experience delays and congestion, but ODOT is committed to minimizing disruptions and providing a safe environment for drivers and workers.*
- Q:** When will the project begin and end?
A: *Construction is scheduled to begin in 2024 and will take approximately two years to complete.*

 Hochatown City Limits



0 3,000 6,000 Feet

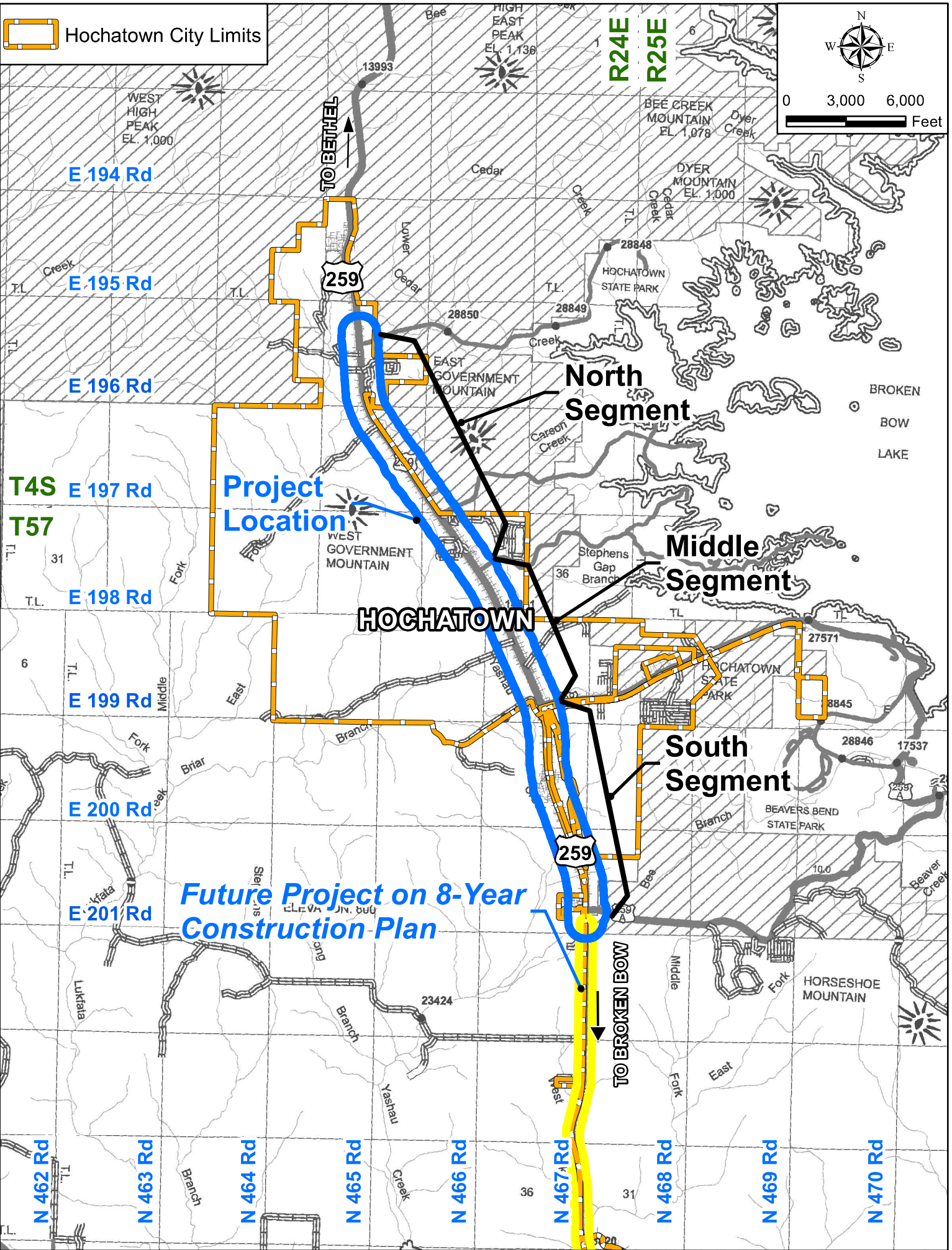

E 194 Rd

E 195 Rd

E 196 Rd

T4S E 197 Rd

T57 E 198 Rd

E 199 Rd

E 200 Rd

E 201 Rd

N 462 Rd
N 463 Rd
N 464 Rd
N 465 Rd
N 466 Rd
N 467 Rd
N 468 Rd
N 469 Rd
N 470 Rd

TO BETHEL

North Segment

Middle Segment

South Segment

HOCHATOWN

Future Project on 8-Year Construction Plan

TO BROKEN BOW

259

259

WEST HIGH PEAK
EL. 1,000

HIGH EAST PEAK
EL. 1,136

BEE CREEK MOUNTAIN
EL. 1,078

DYER MOUNTAIN
EL. 1,000

EAST GOVERNMENT MOUNTAIN

WEST GOVERNMENT MOUNTAIN

HOCHATOWN STATE PARK

BEAVERS BEND STATE PARK

HORSESHOE MOUNTAIN

BROKEN BOW LAKE